

Dryer Vent Boxes

The Premium Dryer Solution

- ✓ No Caulking Needed
- ✓ Eliminates Drywall Repair
- ✓ Reduces Labor Costs

The DBX Dryer Vent Boxes are simple, straightforward dryer vent receptacles that install in the wall behind the clothes dryer in the laundry room. The molded cavity provides storage space for dryer flex hose allowing the clothes dryer to be installed right against the wall. The DBX Dryer Vent Boxes also allow for the elimination of bends and kinks in the dryer flex exhaust hose. This improved airflow allows your dryer to work more efficiently—**saving on energy costs**—and minimizes lint buildup, a well documented fire hazard.

DBX1424

Metal Dryer Vent Box with Optional Trim Ring

The DBX1424 metal dryer vent box with snap on trim ring is powder coated white, designed to work with pedestal and stackable dryers. The 14" wide by 24" tall, 22 gauge metal box and ring is designed to fit into a 2x6 framed wall. The DBX1424 has inside dimensions that are 3 1/2 inches taller than any other manufactured dryer vent box. Thereby, **accommodating all pedestal heights**. This dryer vent box is designed to be used with or without the trim ring.



DBX1000

Plastic Dryer Vent Box

The DBX1000 with snap on trim ring is made of high impact polystyrene. The DBX1000 comes in two sizes 4" (for a 2x4 wall) or 6" (for a 2x6 wall). This dryer vent box can also be used to down vent—simply turn the box upside down.



The snap on trim ring helps eliminate repairs and saves you time.

DBX1000M*

Metal Dryer Vent Box

The DBX1000M dryer vent box is powder coated white, 22 gauge steel, and comes in two sizes 4" (for a 2x4 wall) or 6" (for a 2x6 wall). This dryer vent box can also be used to down vent—simply turn the box upside down. It also comes with a **snap on trim ring**.



DBX900

Dryer Vent Box For Manufactured Housing

The DBX900 was designed specifically for down venting the dryer vent in manufactured housing. The DBX900 dryer vent box is for 2x3 or 2x4 wall framing and does not have a separate trim ring.



Call Today: **866.270.8240**
 Supply Houses Nationwide

* The DBX1000M-4 is able to meet the new 1 hour fire rated code. Please visit newconstructionsolutions.com to download the installation instructions and **Spec-Data sheet**.



1. Product Name

- DBX1000 Dryer Vent Boxes with Snap-On Trim Rings

2. Manufacturer

Construction Solutions, LLC
7801 E. Gray Rd. Suite 110-120
Scottsdale, AZ 85260

Phone: 480-346-8240

Phone: 866-270-8240

Fax: 480-346-8250

Email: jeremyv@newconstructionsolutions.com

Web: www.newconstructionsolutions.com

3. Product Description

The U.S. Consumer Product Safety Commission estimates that 15,500 fires are caused from clothes driers each year, resulting in over \$84 million in associated property losses. To address this critical national need, Construction Solutions, LLC offers its line of DBX1000 dryer vent boxes.

Basic Use

The DBX dryer vent boxes are recessed dryer vent receptacles with trim rings that are expressly designed for four and six inch wall installations. They provide a clean, professional look while reducing construction costs and back-end delays on drywall and paint repair. DBX vent boxes are designed for single-family and multi-family dwelling, in attached and detached configurations.

DBX dryer vent boxes install in the wall behind a clothes dryer in a laundry room. These molded receptacles provide space to accommodate the flex hoses of a dryer, allowing that dryer to be installed flushed against the wall. This also eliminates any bends or kinks in the dryer's exhaust hose. The result is vastly improved airflow that is not only more energy efficient but, more critically, eliminates lint build-up, a major source of house fires.

These vent boxes can be easily converted support down vents by simply turning the box upside down, as well as easily installed in the more typical up vent configuration. Its patented Snap-on trim ring eliminates repairs and save valuable time.

No caulking is required prior to painting. DBX trim Snap-On trim rings eliminate the need to frame the vent box with baseboard. Twelve screw holes are provided to allow secure attachment for the studs.



DBX1000M

Construction and Materials

- DBX1000 Plastic Dryer Vent Boxes with trim ring are constructed of high impact polystyrene (HIPS)
- DBX1000M Metal Dryer Vent Boxes with trim ring are constructed of powder-coated white, 22 gauge steel

Sizes

- Four inches (102 mm) for 2 × 4 walls
- Six inches (152 mm) for 2 × 6 walls

Colors

DBX dryer vent boxes are coated white to match the washer boxes in the laundry rooms.

Features

- Install in up to 24 inches (610 mm) on-center location, with brackets included
- Top and bottom straw clamps for gas pipe
- Snap on trim ring accommodates up to 3/4 inch (19 mm) drywall

4. Technical Data

Applicable Standards

American Society for Materials and Testing (ASTM)

- ASTM E814-13a—Standard Test Method for Fire Tests of Penetration Firestop Systems Standard Test Method for Fire Tests of Penetration Firestop Systems

Standards Council of Canada

- CAN/ULC-S115-11—Standard Method Of Fire Tests Of Firestop Systems

Certifications

Material used in the DBX 1000 meets UL94 HB Flammability Testing and is duly recognized by Underwriters Laboratories Inc.

Note: UL Certificate of Compliance No. 100906-E249870 dated October 9, 2006 pursuant to UL Report Reference E249870 dated August 18, 2006.

Fire Rating

DBX1000M-4 is able to meet the new one-hour fire-rated code. Contact Construction Solutions, LLC for more information.



DBX1000

5. Installation Instructions Online

- DBX1000
- DBX1000M

6. Availability and Cost

Contact Construction Solutions, LLC for details.

7. Warranty

Contact Construction Solutions, LLC for details.

8. Maintenance Instructions

Contact Construction Solutions, LLC for details.

9. Technical Services

Contact Construction Solutions, LLC for details.

10. Filing System

- SpecResources
- Additional product information is available from the manufacturer upon request



Directory of Listed Products



[Go to Directory Page](#)

BUILDING PRODUCTS LISTING PROGRAM

Class: Membrane Penetration

Customer: Construction Solutions, LLC

Location: 7801 E. Gray Rd., Suite 110, Scottsdale, AZ, 85260

Listing No.: B1072-1

Effective Date: December 23, 2014

Last Revised: **No Revisions to Date**

Expires: N/A

Products: Construction Solutions 4 in. and 6 in. Metal Dryer Vent Box with Snap on Trim Ring

Standard(s): ASTM E814 "Standard Test Method for Fire Tests of Penetration Firestop Systems".
CAN/ULC S115 "Standard Method of Fire Tests of Firestop Systems".

Label: 4 in. dryer vent box is marked by Construction Solutions, LLC with the following information: Construction Solutions' 4 in. dryer vent box trade name, QAI listing no. B1072-1A, QAI logo with the 'US' and 'C' identifier, Ratings of 1-hour F, 1-hour T, and 1-hour H (CAN/ULC S115 only).

6 in. dryer vent box is marked by Construction Solutions, LLC with the following information: Construction Solutions' 6 in. dryer vent box trade name, QAI listing no. B1072-1B, QAI logo with the 'US' and 'C' identifier, Ratings of 41-minutes F, 41-minutes T, and 41-minutes H (CAN/ULC S115 only).

Ratings: The following outlines the assembly and ratings of Construction Solutions 4 in. and 6 in. dryer vent box:

Assembly	Test Standard	F-Rating	T-Rating	H-Rating
4 in. Dryer Vent Box	ASTM E814	1-hour	1-hour	N/A
	CAN/ULC S115	1-hour	1-hour	1-hour
6 in. Dryer Vent Box	ASTM E814	41-minutes	41-minutes	N/A
	CAN/ULC S115	41-minutes	41-minutes	41-minutes

Note: ASTM E814 does not use H-Rating to identify that the assembly passed the hose stream test. The hose stream test is a requirement to achieve an F-Rating.

QAI Listing B1072-1A

ASTM E814 and CAN/ULC S115 – 1-Hour F Rating, 1-Hour T Rating, and 1-Hour H Rating (CAN/ULC S115 only) Non-load Bearing Wall Assembly

**QAI Listing B1072-1A Construction Solutions Dryer Vent Box
 CAN/ULC S115, ASTM E814
 1 Hour Membrane Penetration Assembly
 Non-Load Bearing**

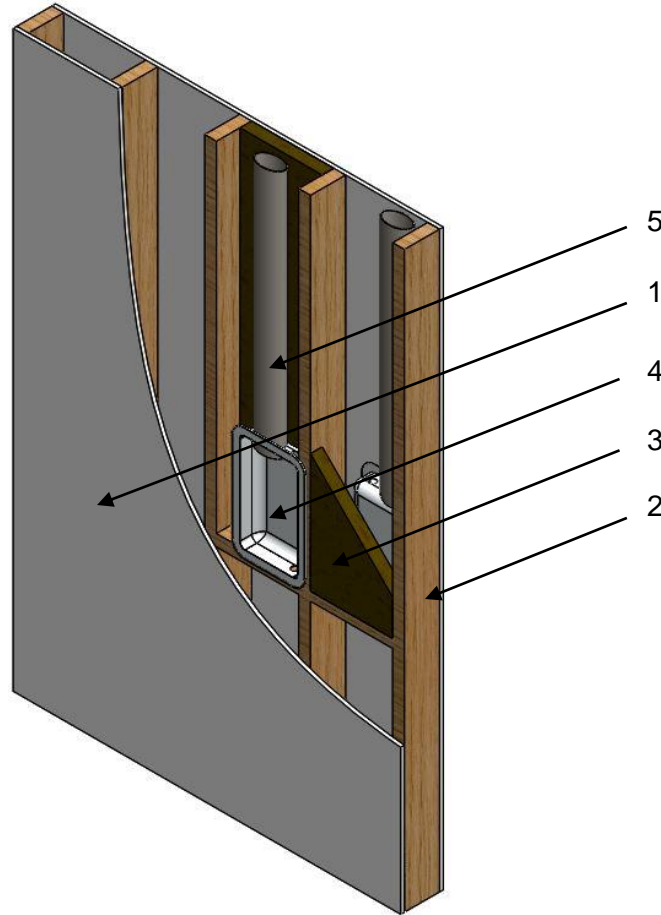

No.	COMPONENT	DESCRIPTION	
1	Gypsum Board	Type:	Type X gypsum wallboard complying with ASTM C1396 and labeled by an approved agency
		Thickness:	Single layer of 5/8 in. (16 mm) on each face of the wall
		Application:	Sheathing is to be fastened to studs with #6 x 1-5/8 in. (41 mm) long coarse thread drywall screws spaced at 8 in. on center. Joints to be taped and mudded, and fastener heads to be mudded.
2	Wall Studs	Stud Type:	Minimum nominal 2 x 6 in. (50 x 152 mm) Wood
		Stud Spaced	Maximum 16 in. (406 mm) on center
3	Insulation	Type:	Mineral wool thermal insulation in compliance with ASTM C612 Type II, III or IVA. ASTM C612 Type II and III mineral wool insulation must also be non-combustible as defined by ASTM E136 and CAN/ULC-S114.
		Minimum Thickness:	2 inch (50 mm)
		Nominal Density:	Minimum 4.0 lb/ft ³ (64 kg/m ³)

No.	COMPONENT	DESCRIPTION	
4	Dryer Vent Box	Certified Manufacturer:	Construction Solutions
		Certified Product:	Nominal 4 in. Construction Solutions Dryer Vent Box Kit
		Box Dimensions:	10 in. (254 mm) wide by 17 in. (432 mm) high by 3-1/2 in. (89 mm) deep with a 1-1/4 in. (32 mm) flange. A 3 x 5 in. (76 x 127 mm) oval cut out for the dryer vent on the top and 1-1/8 in. (29 mm) knockouts on the top and bottom for gas hook up. The box is formed from 22 gauge galvanized steel.
		Trim Ring Dimensions:	9-7/8 in. (251 mm) wide by 16-7/8 in. (429 mm) high by 1-5/8 in. (41 mm) deep with a 1-5/16 in. (33 mm) flange. The trim ring is made from 25 gauge galvanized steel.
		Caulking:	PFP 4800DW
	Installation:	The dryer vent box is fastened to the 2 x 6 in. (50 x 152 mm) stud and sill through three holes on each side of the box using #8 x 1-1/2 in. (38 mm) wood screws. The galvanized steel dryer vent is inserted through the top of the box then caulked at the vent/box interface. The opening cut into the gypsum board shall be a maximum of 10-1/2 in. (267 mm) wide by 17-1/2 in. (445 mm) high. Only one box is permitted per stud cavity.	
5	Vent Pipe	Size:	4 in. (101 mm) Round
		Type:	26 gauge galvanized steel

Visit the QAI Online Listing Directory located at www.qai.org for the most up to date version of this Listing and to validate that this QAI Listing is active.

**QAI Listing B1072-1B Construction Solutions Dryer Vent Box
 CAN/ULC S115, ASTM E814
 30 Minute Membrane Penetration Assembly
 Non-Load Bearing**

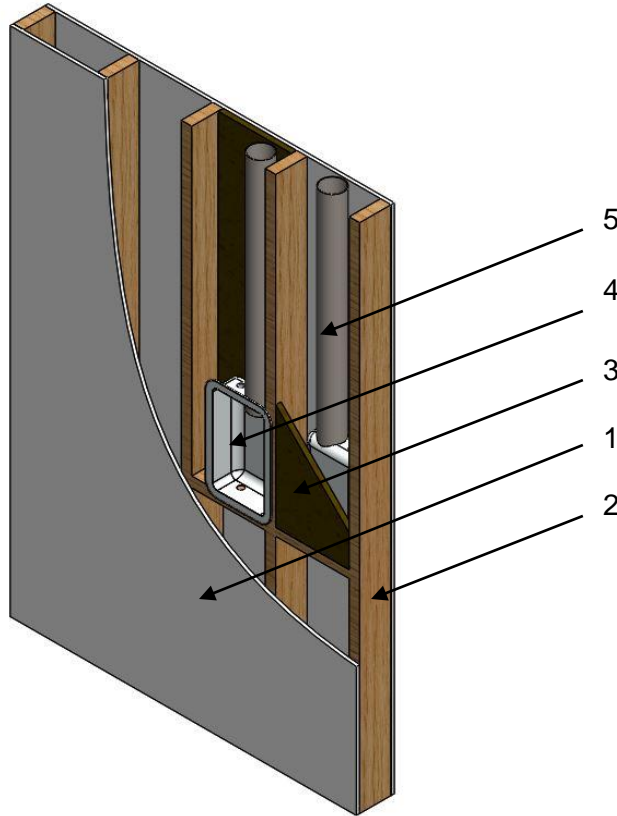

No.	COMPONENT	DESCRIPTION	
1	Gypsum Board	Type:	Type X gypsum wallboard complying with ASTM C1396 and labeled by an approved agency
		Thickness:	Single layer of 5/8 in. (16 mm) on each face of the wall
		Application:	Sheathing is to be fastened to studs with #6 x 1-5/8 in. (41 mm) long coarse thread drywall screws spaced at 8 in. on center. Joints to be taped and mudded, and fastener heads to be mudded.
2	Wall Studs	Stud Type:	Minimum nominal 2 x 6 in. (50 x 152 mm) Wood
		Stud Spaced	Maximum 16 in. (406 mm) on center
3	Insulation	Type:	Mineral wool thermal insulation in compliance with ASTM C612 Type II, III or IVA. ASTM C612 Type II and III mineral wool insulation must also be non-combustible as defined by ASTM E136 and CAN/ULC-S114.
		Minimum Thickness:	2 inch (50 mm). See Insulation Installation below for thickness of insulation behind Dryer Vent Box.
		Nominal Density:	Minimum 4.0 lb/ft ³ (64 kg/m ³)
		Installation:	A 10 in. (254 mm) x 17 in. (432 mm) area shall be cut from the 2 in. cavity insulation in the area behind the Dryer Vent Box, a 10 in. (254 mm) x 17 in. (432 mm) piece of 1 in. insulation shall then be placed in the cut out.

No.	COMPONENT	DESCRIPTION	
4	Dryer Vent Box	Certified Manufacturer:	Construction Solutions
		Certified Product:	Nominal 6 in. Construction Solutions Dryer Vent Box Kit
		Box Dimensions:	10 in. (254 mm) wide by 17 in. (432 mm) high by 5 in. (127 mm) deep with a 1-1/4 in. (32 mm) flange. A 4-3/16 in. (106 mm) circular cut out for the dryer vent on the top and 1-1/8 in. (29 mm) knockouts on the top and bottom for gas hook up. The box is formed from 22 gauge galvanized steel.
		Trim Ring Dimensions:	9-7/8 in. (251 mm) wide by 16-7/8 in. (429 mm) high by 1-5/8 in. (41 mm) deep with a 1-5/16 in. (33 mm) flange. The trim ring is made from 25 gauge galvanized steel.
		Caulking:	PFP 4800DW
	Installation:	The dryer vent box was fastened to the 2 x 6 in. (50 x 152 mm) stud and sill through three holes on each side of the box using #8 x 1-1/2 in. (38 mm) wood screws. The galvanized steel dryer vent is inserted through the top of the box then caulked at the vent/box interface. The opening cut into the gypsum board shall be a maximum of 10-1/2 in. (267 mm) wide by 17-1/2 in. (445 mm) high. Only one box is permitted per stud cavity.	
5	Vent Pipe	Size:	4 in. (101 mm) Round
		Type:	26 gauge galvanized steel

Visit the QAI Online Listing Directory located at www.qai.org for the most up to date version of this Listing and to validate that this QAI Listing is active.



June 24, 2015

To: Whom it may Concern

RE: QAI Laboratories Accreditations

QAI Laboratories is an international company with 4 offices in the US and 3 offices in Canada. QAI is accredited in both the United States and Canada. In the United States QAI Laboratories is accredited by the US Government Department of Labor, Occupational Safety and Health Administration (OSHA) as a Nationally Recognized Testing Laboratory (NRTL), we are also accredited by the International Accreditation Services (IAS) as a Testing Laboratory and a Certification Agency and by the American Association of Laboratory Accreditation (A2LA) and the Federal Communication Commission (FCC) as an EMC/EMI testing laboratory and Conformity Assessment Body (CAB). In Canada we are accredited by the Standards Council of Canada (SCC) and also Industry Canada (IC) for (EMC/EMI).

With specific reference to Fire resistance evaluation of products our scope of accreditation is equivalent to that of other agencies like UL or Intertek. We are all accredited by the above noted agencies to ISO 17065 standard for Certification of Fire rated products and the ISO 17025 standard for testing of these products. It should also be noted QAI is a major partner to ICC-ES providing many of their testing and inspection services.

For details of our scope please visit <http://qai.org/accreditations/>

For specifics on the Constructions Solutions listing and use limitations please see QAI's online listing page at:

http://www.qai.org/Listing_Pages/QAI_Listing_B1072_Construction_Solutions.htm

Should you require any additional information on our accreditations please do not hesitate to call 604-527-8378.

Regards

Lawrence Gibson, P. Eng.,
President



CERTIFICATE OF PARTICIPATION

Issued by
UL LLC

QAI LABORATORIES INC.

1325 N 108TH EAST AVE, TULSA, OK 74116-5638, USA

has been assessed and found to be eligible to participate in the

Third Party Test Data Program (TPTDP)

DA File: DA1135
Issued: 2014-07-22
Expires: 2015-07-14

A handwritten signature in black ink, appearing to read 'Bruce R. Proper', is located above the printed name.

Bruce R. Proper
Global Process Owner, Data Acceptance Program

INSTALLATION INSTRUCTIONS FOR THE DBX1000M 4" Dryer Vent Box 22 GAUGE METAL DRYER VENT BOX/TRIM RING

The DBX1000M-4 is 9 3/4" X 17" X 3 1/2" deep.

The DBX1000M-4 can be installed in either 2"x 4" or 2"x 6" wood or 3 5/8" or 6" metal framing.

It is a 22 gauge metal dryer vent box with a 25 gauge snap-on trim ring. It can be installed in 16" or 24" o.c. framing. The DBX1000M-4 is powder coated.

For optimum results install the Construction Solutions DBX1000M-4 for up or down venting in 2"x 4" or 2"x 6" wood or 3 5/8" or 6" metal framed walls as follows.



BOX INSTALLATION – 16" or 24" O.C. (on center) SPACING

- ❶ Orient box to match desired venting direction. Allow a minimum of 4" vent pipe to extend into the box.
- ❷ If gas line is to be installed, insert into knockout provided.
- ❸ Slide box into position taking care to correctly align vent pipe and gas pipe (if present).
- ❹ Set box so that the bottom is 2 5/8" above the floor to allow clearance for the trim ring. If the dryer is a stackable or on a pedestal the box can be properly aligned with the dryer exhaust.
- ❺ Attach the box directly to either framing member.
- ❻ Screws or nails (1 1/4" in length) to attach the DBX1000M to framing.

INSTALLATION INSTRUCTIONS FOR A 1 HOUR FIRE WALL REQUIREMENT

- ❺ To achieve a penetration firestop system rating (one hour equal F&T) 2"x 6" (50x152mm) wood framing 16" o.c. (406mm) is required. The DBX1000M-4 is to be installed in accordance with the QAI assembly description. Insulation to be 2" (50mm) mineral wool thermal insulation in compliance with ASTM C553 Type VII nominal density minimum 4.0 lb/ft³ (64 kg/m³) installed in back of the DBX1000M-4 dryer vent box. One single layer of 5/8" Type X gypsum board complying to ASTM 1396 fastened using # 6x 1 5/8" coarse thread drywall screws spaced 8" o.c. to the face of the framing with joints taped and compound applied. Tape embedded in the first layer. Apply compound to screw heads. A nominal 2" x 4" (50x100mm) stud is installed into the stud cavity 10 3/4" (273 mm) from a 2" x 6" (50x152mm) stud. The dryer vent box is fastened to the 2" x 4" and the 2" x 6" studs with wood screws. Where the steel exhaust pipe is inserted into the vent box it shall be caulked with PFP 4800DW caulking at the interface (PFP 4800DW meets ASTM E814, CAN/ULC S115). The vent pipe is 4" (101mm), 26 gauge galvanized steel.
- ❻ Trim ring dimension 9 7/8" X 16 7/8" X 1 5/8", 25 gauge galvanized steel.



See QAI Report # B1072-1
Fire Test of Penetration Firestop Systems

Ratings (see QAI directory B1072-1)	ASTM E 814	CAN/ULC S115
F Rating	1 Hour	1 Hour
T Rating	1 Hour	1 Hour
H Rating	N/A	1 Hour



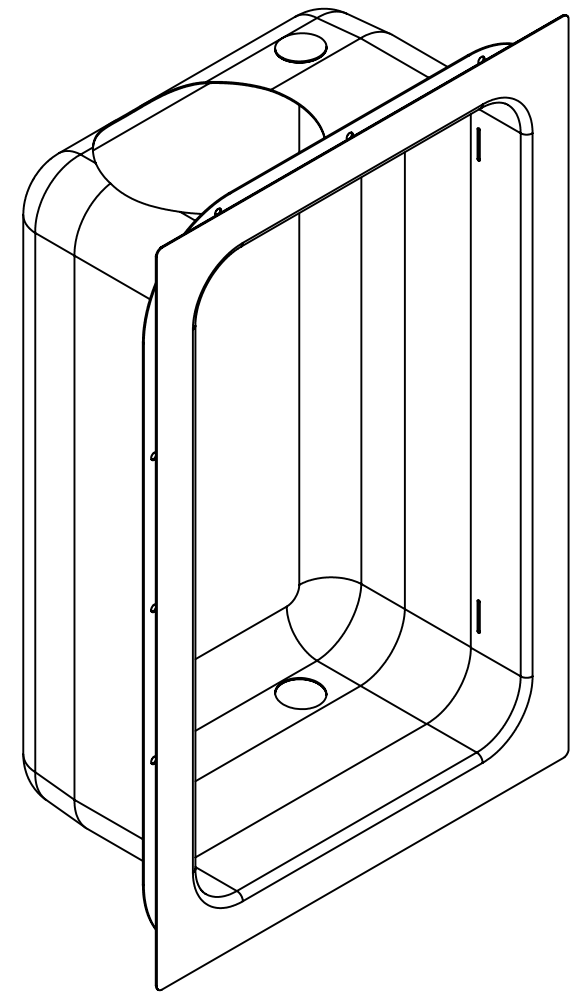
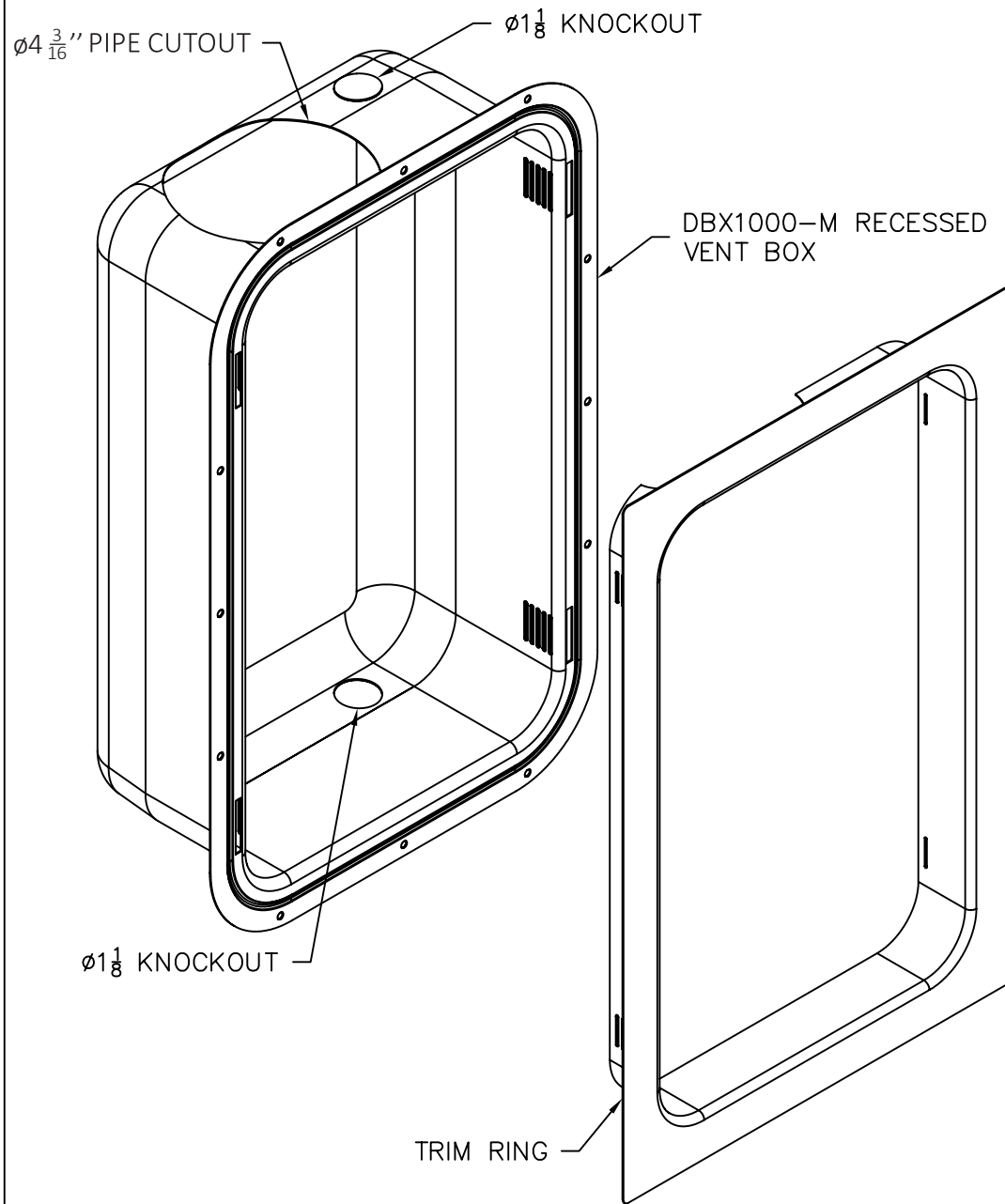

DBX1000M 6"
 DRYER VENT BOX
 ASSEMBLY VIEW

CONSTRUCTION
 SOLUTIONS

DBX1000M 6" DRYER VENT BOX
 WITH SNAP ON TRIM RING

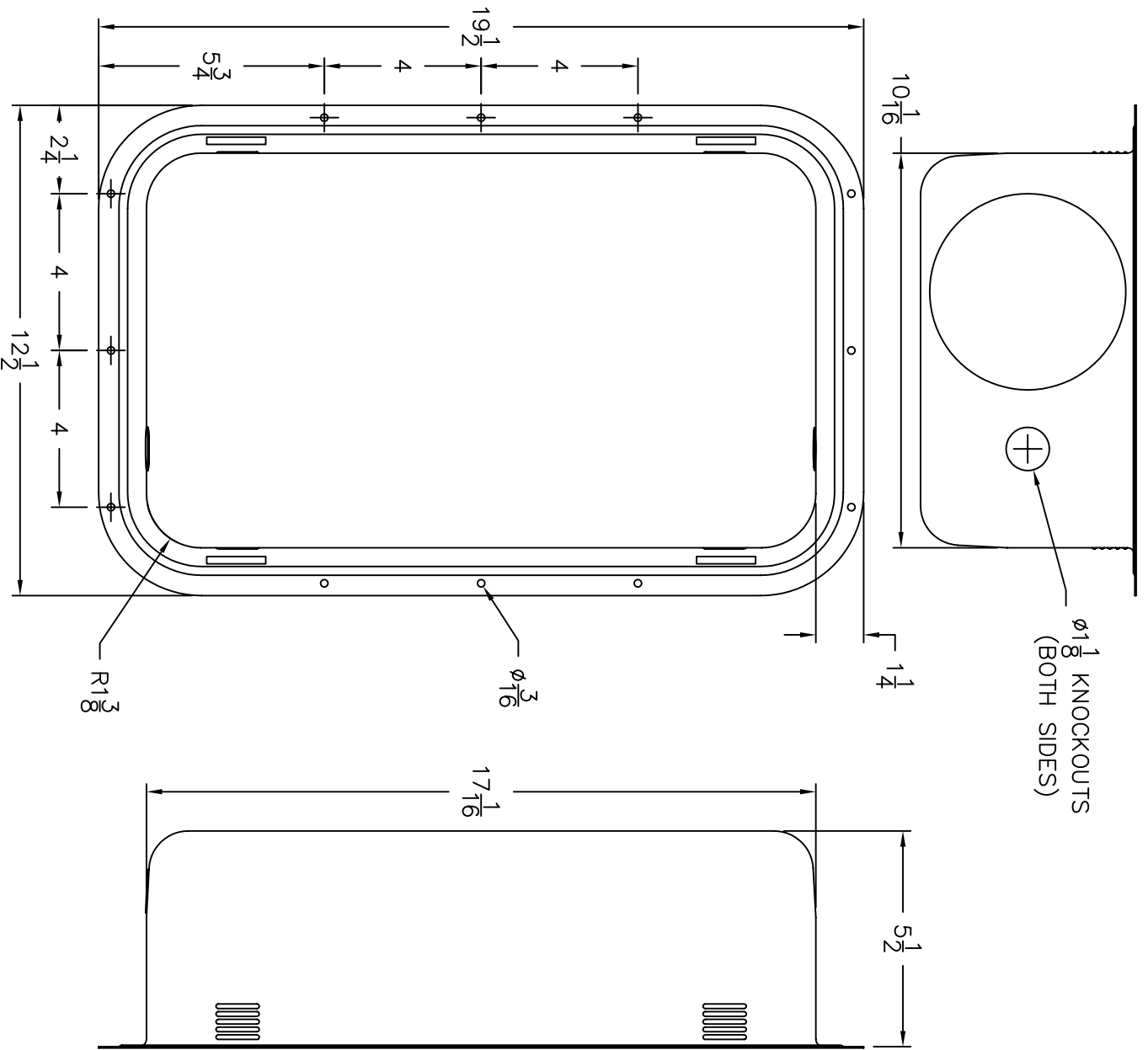

DBX1000M
 6" DRYER
 VENT BOX
 DIMENSION
 VIEW

CONSTRUCTION
 SOLUTIONS

DBX1000-M 6"
 DRYER VENT BOX
 10-5-07

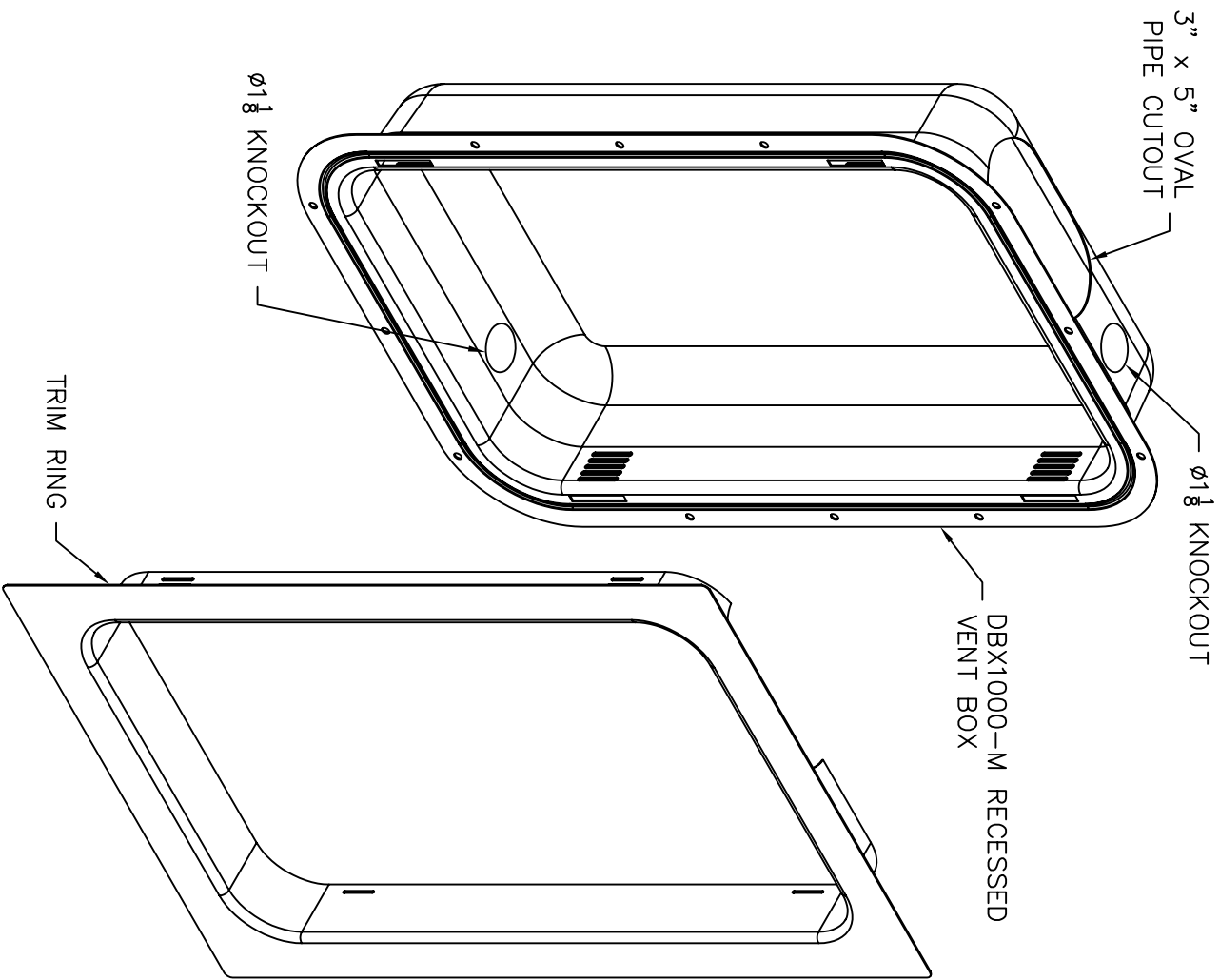

DBX1000M **4**
 ASSEMBLY VIEW

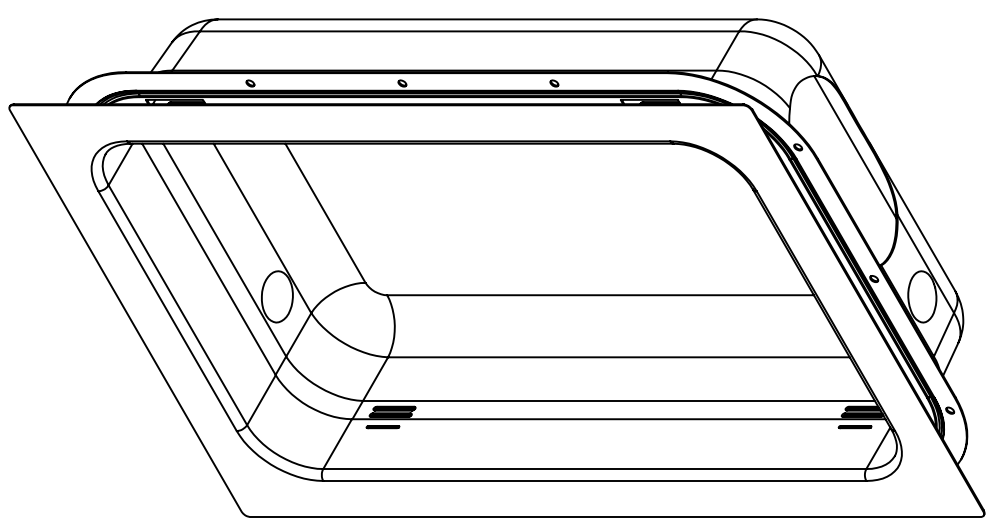

CONSTRUCTION
 SOLUTIONS

DBX1000-M
 DIMENSION VIEW
 10-5-07

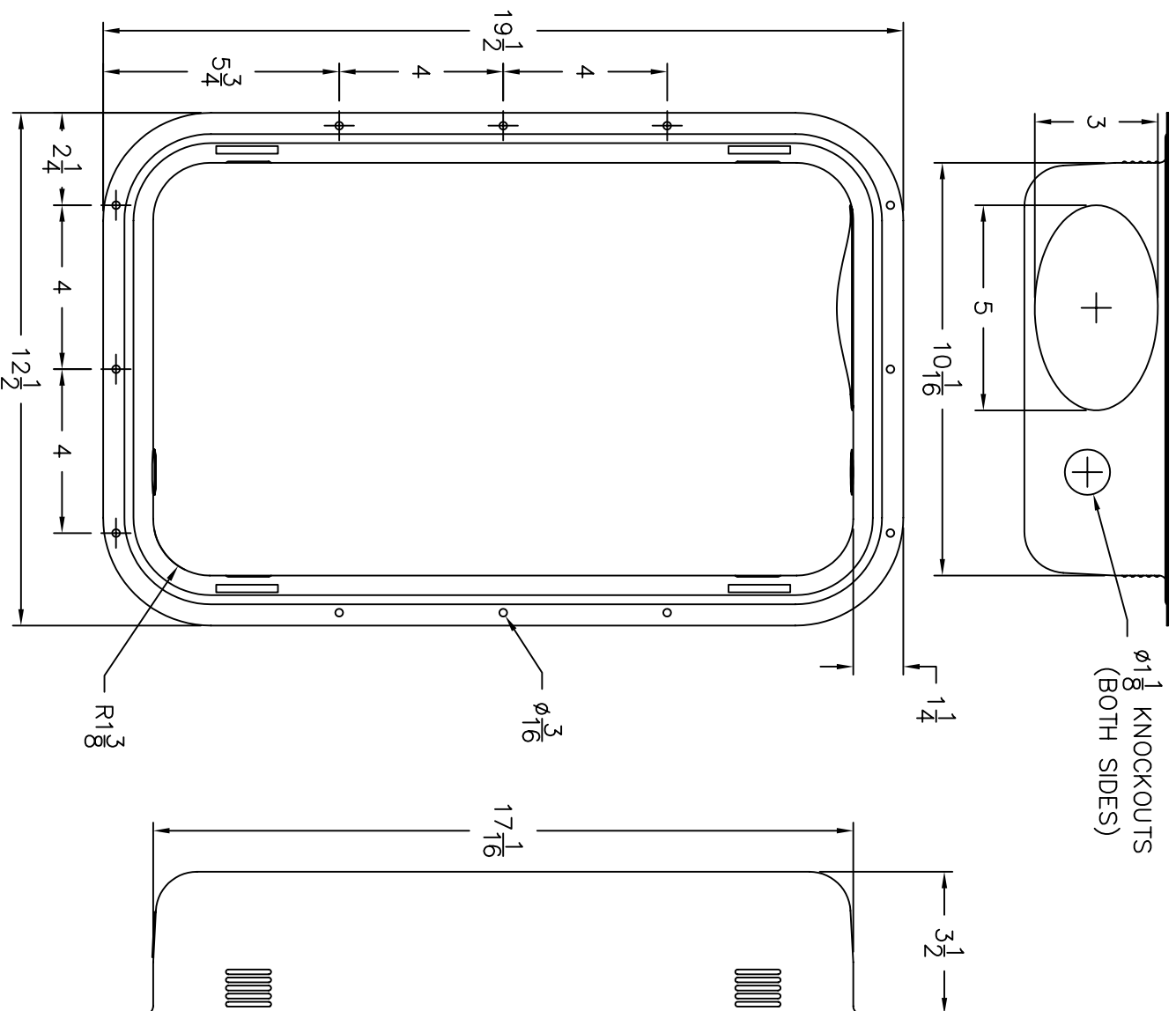

DBX1000M4 BOX
DIMENSION VIEW

CONSTRUCTION
SOLUTIONS

DBX1000-M
DIMENSION VIEW
10-5-07

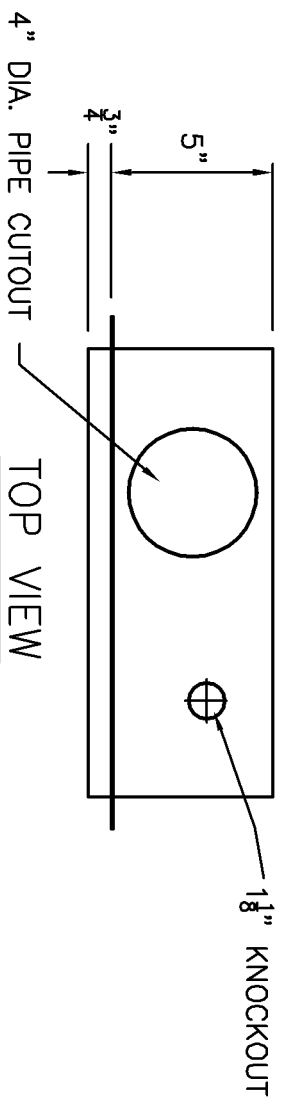

DBX1424
DRYER VENT BOX
DIMENSION VIEW

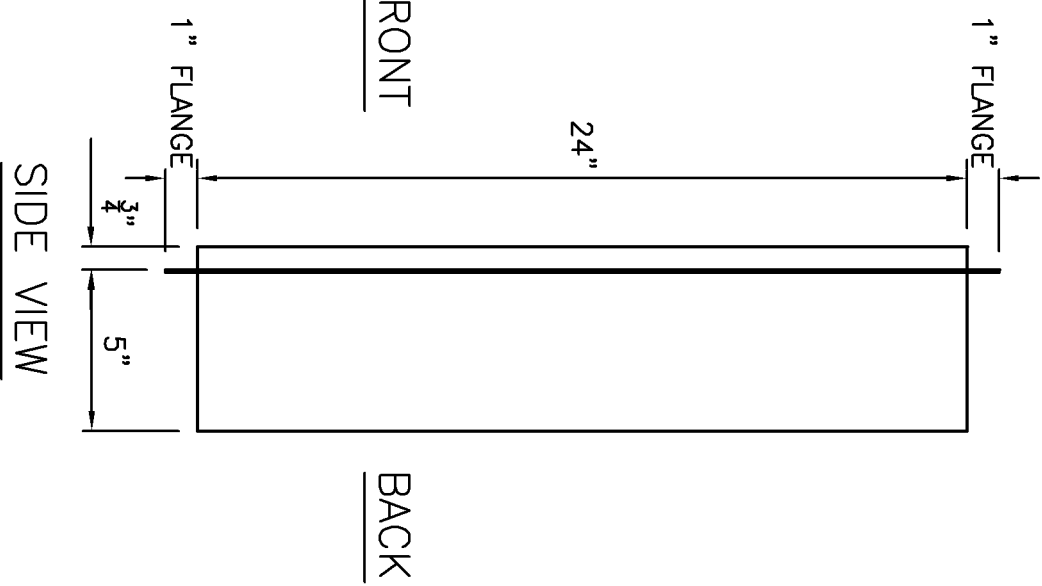
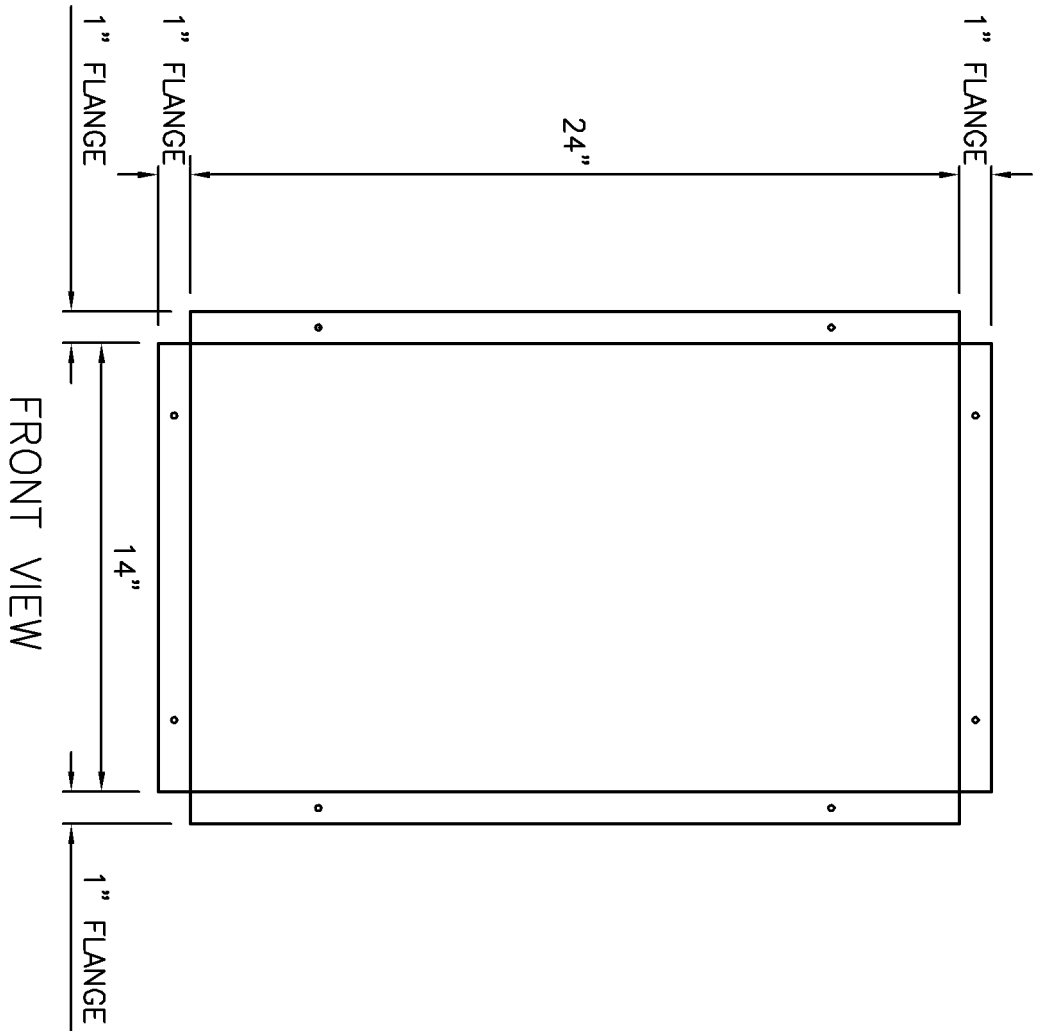

CONSTRUCTION
SOLUTIONS

7801 East Gray Rd., #1110
Scottsdale, AZ 85260
Office: 480-346-8240
www.newconstructionsolutions.com

DBX1424
DRYER VENT BOX

DBX1424
DRYER VENT BOX
ASSEMBLY VIEW

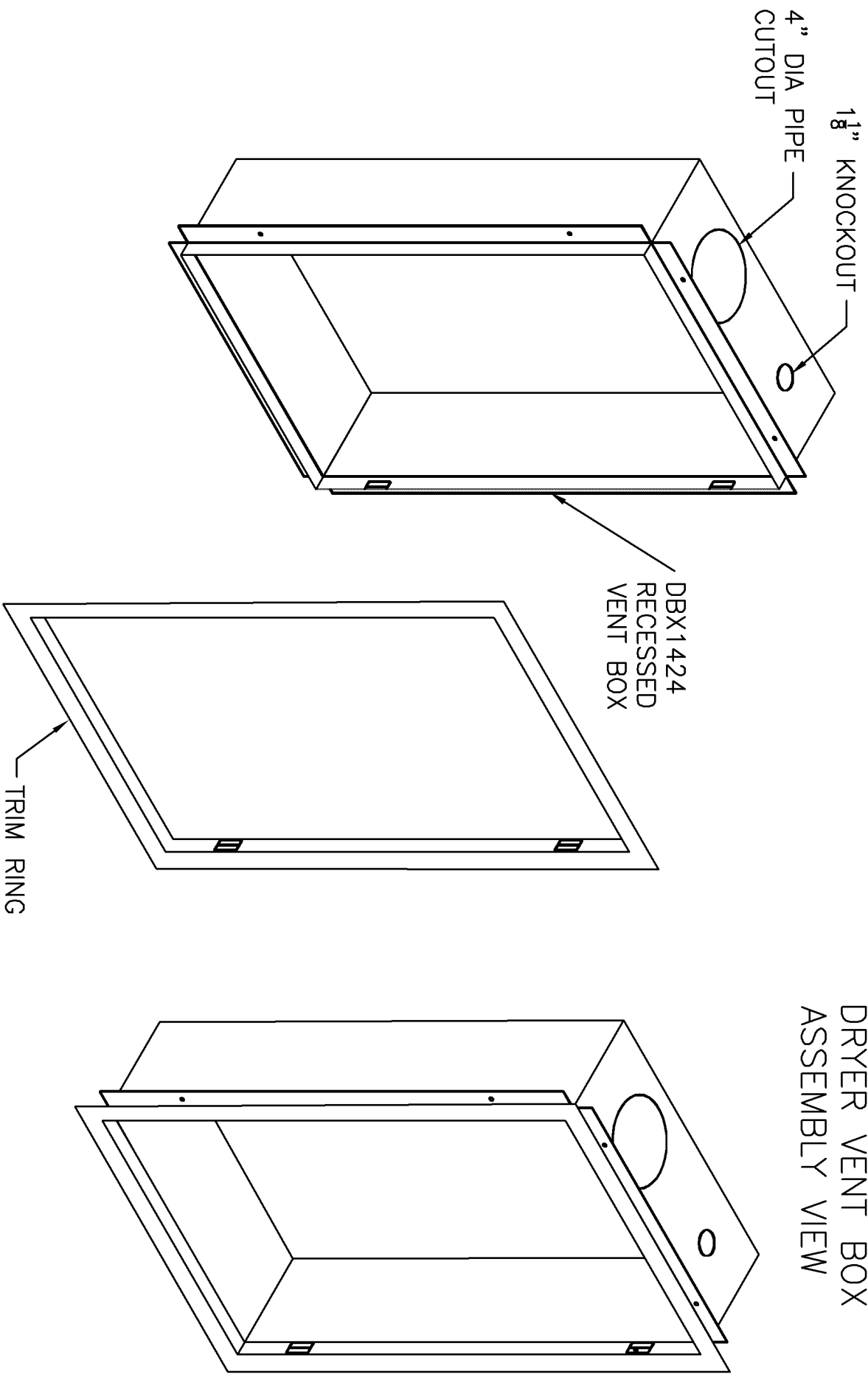

CONSTRUCTION
SOLUTIONS

7801 East Gray Rd., #110
Scottsdale, AZ 85260
Office: 480-346-8240
www.newconstructionolutions.com

DBX1424
DRYER VENT BOX