



MODEL LPD

LOW PROFILE DIRECT DRIVE CENTRIFUGAL ROOF/SIDEWALL EXHAUSTER

CENTRIFUGAL ROOF & WALL EXHAUSTERS

FEATURES

- Ultra Low Profile
- AMCA Air & Sound Licensed
- UL 705 Listed
- UPS Shipping Carton
- 5 Year Housing Warranty
- Up To 140°F Airstream Temperature
- Roof or Sidewall Mount



CONSTRUCTION

- Aluminum Construction
- Stainless Steel Exterior Fasteners
- Backward Curved Centrifugal Wheel
- Aluminum Birdscreen
- Conduit Wiring Chase
- Service Disconnect Switch
- Precision Balanced to ISO Standard 1940

AMCA SEAL



Soler & Palau USA, certifies that the Models LPD shown herein are licensed to bear the AMCA Seal. The ratings shown are based on test and procedures performed in accordance with AMCA Publication 211 and AMCA Publication 311 and comply with the requirement of the AMCA Certified Ratings Program.



LISTED POWER ROOF VENTILATOR
UL STANDARD 705

MOTOR

- Unique External Rotor Design
- Permanently Lubricated Bearings
- 3 Year Motor Warranty
- Internal Thermal Protection
- 100% Speed Controllable
- Totally Enclosed and Continuous Duty

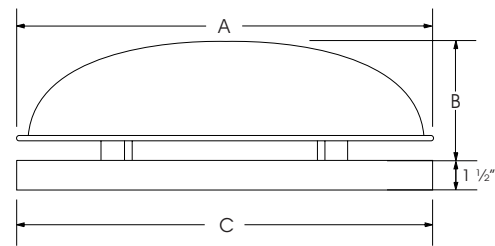

Dimensional Data							
Size	O.D. Damper	Roof Opening	Curb O.D.	A	B	C	Average Ship Wt. Lbs.
6	11	11-3/4	14-3/4	16-1/2	7	16-1/2	12
8	11	11-3/4	14-3/4	16-1/2	7	16-1/2	15

MODEL LPD	CFM @ STATIC PRESSURE											RPM (NOM.)	MAX MOTOR WATTS & AMPS	SONES @ 1/2"	VENTILATOR WITH TE MOTOR	
	0	1/8	1/4	3/8	1/2	5/8	3/4	1	1 1/4	1 1/2	1 3/4				115/1/60 STOCK NO.	230/1/50-60 STOCK NO.
6	302	268	247	222	197	175	155	118	87	52	-	2800	90 WATTS 0.8 AMPS	7.2	LPD061AS	N/A
8	387	358	331	303	275	245	222	178	138	28	63	2775	115 WATTS 1.0 AMPS	11.9	LPD081AS	N/A

MODEL LPD	12" HIGH ROOF CURB	GRAVITY DAMPER	115 VOLT SPEED CONTROL
	STOCK NO.	STOCK NO.	STOCK NO.
6	611214	411011	2727.1
8	611214	411011	2727.1

Performance certified is for installation type A-free inlet, free outlet. Performance ratings include the effects of birdscreen in the airstream. The sound ratings shown are loudness values in fan sones @ 5' (1.5m) in a hemispherical free field calculated per AMCA Standard 301. Values shown are for installation Type A-free inlet fan sones levels.

*Base unit=AMCA Seal for Sound Rating does not apply to units with speed control + RPM range capable with solid state speed control. Speed (RPM) shown is normal. Performance is based on actual speed of test.

ALL DIMENSIONS IN INCHES, WEIGHTS IN POUNDS. OD IS OUTSIDE DIMENSION OF SQUARE CURB AND DAMPER. DUE TO CONTINUING RESEARCH, SOLER & PALAU RESERVES THE RIGHT TO CHANGE SPECIFICATIONS WITHOUT NOTICE.



MODEL DB DOWNBLAST BELT DRIVE CENTRIFUGAL ROOF EXHAUSTER

APPLICATION

Model DB belt drive units are used for the exhaust of relatively clean air from a wide range of commercial, industrial and institutional environments such as manufacturing and assembly plants, office buildings, schools, hospitals, restaurants, athletic facilities and many others.

The nonoverloading wheel with its higher static pressure capabilities makes this unit suitable for either ducted or nonducted applications. Its roof mounting permits location near the area to be ventilated, allowing short duct runs and more efficient operation.

The aluminum exterior provides an attractive appearance. Belt drive results in lower operating RPM and sound levels, making the Model DB well suited to applications where quiet operation is important. Belt drive also permits easy performance adjustments when needed to balance the total ventilation system.

CONSTRUCTION

Housing

- Heavy gauge aluminum for extra strength with prepunched mounting hole.
- Neoprene isolators for reduction of vibration and sound.
- Cover easily removed for quick access to motor compartment.
- Water tight conduit tube for easy electrical connection from below roof.
- Aluminum birdscreen and disconnect are included on standard models.
- Stainless steel exterior fasteners.

Centrifugal Wheel

- All aluminum backward inclined wheel.
- Nonoverloading for safe operation in ducted systems.
- Statically and dynamically balanced for smooth operation.

Drives

- Sized for minimum 150% of drive horsepower.
- Machined cast iron adjustable motor pulleys.
- Adjustable base for belt tensioning.
- Non static oil resistant v-belts.

DIMENSIONAL DATA

MODEL DB	A	B	C	D	MOTOR COVER OD	CURB CAP FLANGE	ROOF OPENING	Average Ship Wt. Lbs.
6-8-9	20 1/2	17 1/2	16 1/2	3 1/2	16 1/4	1 3/4	11 1/2	65
11-12-14	28 3/8	23	24	3 1/2	22 1/4	2	19 1/2	120
16	32 1/4	24	24	6	26 1/4	2 1/2	19 1/2	140
18	32 1/2	24	29 1/2	4 1/2	26 1/4	2 1/2	24 3/4	160
20	36 3/4	25	29 1/2	4 1/2	26 1/4	2 1/2	24 3/4	215
24	41 1/4	26 1/2	35 3/4	7 1/2	30	2 1/2	30 3/4	270
30	58 3/8	37	42 1/2	5 1/2	41	2 1/2	37 3/4	465
36	58 3/8	37	42 1/2	10	41	2 1/2	37 3/4	475
42	73	40 1/2	55	9 1/2	54 5/8	2 1/2	50 1/4	525
48	73	40 1/2	55	13	54 5/8	2 1/2	50 1/4	780

MODEL DB	RECOMMENDED 12" HIGH MOUNTING CURB		RECOMMENDED GRAVITY DAMPER		FAN LESS MOTOR & DRIVE
	OD	STOCK NO.	OD	STOCK NO.	STOCK NO.
6-8-9	15	611214	11	411011	DB06LMDS-DB08LMDS-DB09LMDS
11-12-14	22 1/4	611222	18	411018	DB11LMDS-DB12LMDS-DB14LMDS
16	22 1/4	611222	18	411018	DB16LMDS
18	27 3/4	611227	24	411024	DB18LMDS
20	27 3/4	611227	24	411024	DB20LMDS
24	33 3/4	611233	30	411030	DB24LMDS
30	40 3/4	611240	36	611036	DB30LMDS
36	40 3/4	611240	36	611036	DB36LMDS
42	53 1/4	611253	48	611048	DB42LMDS
48	53 1/4	611253	48	611048	DB48LMDS

ALL DIMENSIONS IN INCHES, WEIGHTS IN POUNDS. OD IS OUTSIDE DIMENSION OF SQUARE CURB AND DAMPER. DUE TO CONTINUING RESEARCH, SOLER & PALAU RESERVES THE RIGHT TO CHANGE SPECIFICATIONS WITHOUT NOTICE.



Motors

- Single speed open drip-proof are standard.
- All motors are rated for continuous duty.
- 182T and larger motors shipped unmounted for field installation.
- Disconnect switch standard with single speed drip-proof motors.

Bearings

- Heavy duty ball bearing type.
- Pre-lubricated and permanently sealed.

AMCA SEAL



Soler & Palau USA, certifies that the Models DB shown herein are licensed to bear the AMCA Seal. The ratings shown are based on test and procedures performed in accordance with AMCA Publication 211 and AMCA Publication 311 and comply with the requirement of the AMCA Certified Ratings Program.



LISTED POWER ROOF VENTILATOR
UL STANDARD 705

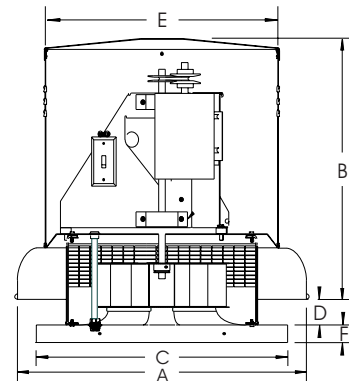

MODEL DB

Downblast Belt Drive Centrifugal Roof Exhauster

Ventilator with Open Drip-proof
Motor and Drive Assembly

Model DB	Motor Hp	Max. BHP	RPM	Sones @ 1/4 SP	CFM at Static Pressure										115/1/60*		208-230/460/3/60	
					0	1/8	1/4	3/8	1/2	5/8	3/4	1	1 1/4	Stock No.	Stock No.			
6	1/4	0.10	1400	6.2	459	412	358	295	217	-	-	-	-	DB06MLIS	N/A			
	1/4	0.18	1700	9.4	558	521	478	432	380	325	255	-	-	DB06MHIS	N/A			
8	1/4	0.08	1170	5.1	861	747	604	391	-	-	-	-	-	DB08MLIS	N/A			
	1/4	0.14	1410	7.7	1037	945	839	715	553	249	-	-	-	DB08MMIS	N/A			
	1/4	0.25	1700	11.2	1250	1176	1095	1002	900	785	634	-	-	DB08MHIS	N/A			
9	1/4	0.20	1310	6.6	1339	1238	1112	941	720	390	-	-	-	DB09MHIS	N/A			
	1/3	0.33	1550	9.3	1584	1501	1406	1290	1145	973	760	-	-	DB09PHIS	N/A			
11	1/4	0.26	1535	11.4	1634	1535	1430	1315	1187	1059	918	527	-	DB11MHIS	DB11MH3S			
	1/3	0.34	1685	13.5	1793	1704	1609	1510	1400	1281	1165	894	485	DB11PHIS	DB11PH3S			
12	1/4	0.27	1280	12.1	1919	1801	1676	1536	1383	1215	992	-	-	DB12MHIS	DB12MH3S			
	1/3	0.35	1390	13.9	2084	1976	1862	1740	1603	1461	1301	839	-	DB12PHIS	DB12PH3S			
	1/2	0.53	1600	17.8	2399	2306	2209	2108	2001	1882	1760	1489	1109	DB12QHIS	DB12QH3S			
14	1/4	0.18	875	8.2	2004	1857	1680	1439	1065	-	-	-	-	DB14MHIS	DB14MH3S			
	1/3	0.34	1075	12.0	2462	2346	2215	2067	1885	1642	1328	-	-	DB14PHIS	DB14PH3S			
	1/2	0.50	1225	15.2	2806	2705	2595	2474	2340	2183	1988	1408	-	DB14QHIS	DB14QH3S			
	3/4	0.75	1400	19.2	3207	3119	3026	2926	2819	2703	2572	2240	1782	DB14RHIS	DB14RH3S			
16	1/4	0.26	800	8.3	2970	2674	2320	1905	1205	-	-	-	-	DB16MHIS	DB16MH3S			
	1/3	0.34	870	9.8	3230	2958	2649	2293	1853	965	-	-	-	DB16PHIS	DB16PH3S			
	1/2	0.52	1000	12.7	3712	3476	3228	2939	2623	2256	1712	-	-	DB16QHIS	DB16QH3S			
	3/4	0.79	1155	16.7	4288	4084	3878	3648	3395	3125	2831	1980	-	DB16RHIS	DB16RH3S			
18	1/3	0.33	805	10.8	3056	2838	2579	2274	1873	-	-	-	-	DB18PHIS	DB18PH3S			
	1/2	0.52	940	14.0	3568	3385	3183	2944	2681	2358	1965	-	-	DB18QHIS	DB18QH3S			
	3/4	0.78	1075	17.8	4080	3922	3752	3563	3351	3123	2863	2167	-	DB18RHIS	DB18RH3S			
	1	0.99	1165	21.0	4422	4276	4123	3957	3770	3570	3356	2824	-	DB18SHIS	DB18SH3S			
	1 1/2	1.52	1345	26.0	5105	4979	4849	4713	4569	4408	4237	3873	3434	DB18THIS	DB18TH3S			
	2	2.02	1480	31.0	5618	5504	5386	5265	5139	5005	4859	4546	4206	DB18VHIS	DB18VH3S			
20	1/3	0.35	665	8.7	3562	3318	3021	2658	2145	1281	-	-	-	DB20PHIS	DB20PH3S			
	1/2	0.52	760	10.7	4071	3861	3625	3338	3007	2567	1963	-	-	DB20QHIS	DB20QH3S			
	3/4	0.79	875	13.9	4687	4506	4312	4091	3838	3560	3210	2229	-	DB20RHIS	DB20RH3S			
	1	1.12	985	17.5	5276	5117	4949	4768	4562	4336	4098	3476	2589	DB20SHIS	DB20SH3S			
	1 1/2	1.56	1100	22.0	5892	5750	5602	5447	5280	5092	4889	4451	3874	DB20THIS	DB20TH3S			
	2	2.08	1210	26.0	6482	6353	6220	6082	5937	5782	5610	5241	4821	DB20VHIS	DB20VH3S			
24	1/3	0.33	490	8.6	4879	4400	3751	2388	-	-	-	-	-	DB24PHIS	DB24PH3S			
	1/2	0.49	560	11.5	5576	5169	4688	3972	2614	-	-	-	-	DB24QHIS	DB24QH3S			
	3/4	0.75	645	14.3	6422	6078	5683	5219	4557	3374	1906	-	-	DB24RHIS	DB24RH3S			
	1	1.00	710	17.2	7069	6761	6412	6033	5549	4848	3773	-	-	DB24SHIS	DB24SH3S			
	1 1/2	1.54	820	22.0	8164	7902	7613	7299	6968	6567	6073	4360	-	DB24THIS	DB24TH3S			
	2	2.04	900	26.0	8961	8723	8467	8190	7899	7590	7218	6180	4490	DB24VHIS	DB24VH3S			
30	1/2	0.52	410	6.6	7098	6406	5512	4350	2246	-	-	-	-	DB30QHIS	DB30QH3S			
	3/4	0.76	465	7.7	8050	7456	6735	5866	4743	2961	-	-	-	DB30RHIS	DB30RH3S			
	1	1.03	515	8.7	8916	8388	7775	7074	6215	5132	3571	-	-	DB30SHIS	DB30SH3S			
	1 1/2	1.55	590	10.6	10214	9761	9257	8683	8030	7315	6472	3860	-	DB30THIS	DB30TH3S			
	2	2.13	655	13.1	11339	10936	10496	10010	9469	8871	8231	6617	4024	DB30VHIS	DB30VH3S			
	3	3.13	745	16.7	12897	12546	12171	11768	11332	10857	10343	9220	7827	N/A	DB30WH3S			
36	3/4	0.80	355	9.1	10134	9166	7936	5730	-	-	-	-	-	DB36RHIS	DB36RH3S			
	1	1.02	385	10.3	10990	10122	9075	7268	5137	-	-	-	-	DB36SHIS	DB36SH3S			
	1 1/2	1.58	445	13.0	12703	11985	11118	10124	8417	6731	-	-	-	DB36THIS	DB36TH3S			
	2	2.11	490	15.7	13987	13351	12574	11770	10712	8982	7516	-	-	DB36VHIS	DB36VH3S			
	3	3.15	560	20.0	15986	15445	14803	14106	13387	12494	11151	8338	-	N/A	DB36WH3S			
	5	5.16	660	27.0	18840	18393	17884	17315	16722	16130	15470	13586	11030	N/A	DB36XH3S			
42	1 1/2	1.56	340	12.9	16051	14909	13323	11079	7073	-	-	-	-	DB42THIS	DB42TH3S			
	2	2.18	380	15.8	17940	16925	15681	14051	11690	7879	-	-	-	DB42VHIS	DB42VH3S			
	3	3.05	425	19.1	20064	19158	18187	16827	15279	13084	10122	-	-	N/A	DB42WH3S			
	5	5.11	505	26.0	23841	23076	22309	21432	20267	19070	17584	13399	-	N/A	DB42XH3S			
48	3	2.96	345	15.3	21003	19243	17628	15033	12358	9228	5498	-	-	N/A	DB48WH3S			
	5	5.16	415	21.0	25041	23683	22249	20797	19140	17240	14643	8394	-	N/A	DB48XH3S			

CENTRIFUGAL ROOF & WALL EXHAUSTERS

Power ratings (BHP) do not include transmission losses.

Performance certified is for installation type A-free inlet, free outlet. Performance ratings include the effects of birdscreen in the airstream.

The sound ratings shown are loudness values in fan sones @ 5' (1.5m) in a hemispherical free field calculated per AMCA Standard 301.

Values shown are for installation Type A-Free inlet fan sone levels.

*Tri-voltage (115-208-230) is standard on 3/4 through 1 1/2 Hp Single phase motors. Tri-voltage is available for the 1/2 Hp motors. Inquire for price and delivery.

575/3/60 ODP Motors are available for most motor HP's - Refer to Price List.



MODEL RED DOWNBLAST DIRECT DRIVE CENTRIFUGAL ROOF EXHAUSTER

APPLICATION

Model RED direct drive units are used to exhaust air from all types of commercial and institutional buildings such as hospitals and health care facilities, schools, recreational buildings, machinery and equipment rooms, offices, retail stores and similar applications.

The non overloading wheel with its higher static pressure capability makes this unit suitable for either ducted or nonducted applications. It's roof mounting permits location near the area to be ventilated, allowing short duct runs and more efficient operation.

The spun aluminum exterior provides an attractive appearance and is compatible with belt driven Model DB and companion gravity units to make up a complete ventilation system. Direct drive units use smaller diameter wheels, resulting in low sound levels and quiet operation. They have no belts or fan bearings to maintain or adjust and consequently require very little maintenance.

CONSTRUCTION

Housing

- Curb cap has prepunched mounting holes for ease of installation.
- Fan plate isolates motor compartment from contaminated exhaust air.
- Spun aluminum hood and skirt for weather protection and attractive appearance.
- Heavy gauge motor support for rigidity and strength
- Neoprene isolators for reduction of vibration and sound.
- Quick access to motor compartment for ease of maintenance.
- Conduit passage for easy electrical connection from below roof.
- Aluminum birdscreen and disconnect are included on standard models.

Centrifugal Wheel

- Non overloading for safe operation in ducted systems.
- Backward inclined wheels constructed of non-corrosive aluminum.
- Statically and dynamically balanced for smooth operation.

Speed Controllable Motors

- Standard motors are single speed, speed controllable and drip-proof.
- All motors are rated for continuous duty.
- Disconnect is standard with single speed drip-proof motors.
- Motors ship mounted as standard.

DIMENSIONAL DATA

MODEL RED	A	B	C	D	ROOF OPENING	Average Ship Wt. Lbs.
6	21 3/4	16 3/4	16 1/2	1 3/4	11 3/4	48
8	21 3/4	16 3/4	16 1/2	1 3/4	11 3/4	48
10	21 3/4	16 3/4	16 1/2	1 3/4	11 3/4	67
12	33 1/8	23 1/2	24	2 1/2	19 1/4	102
15	33 1/8	23 1/2	24	2 1/2	19 1/4	125

MODEL RED	RECOMMENDED 12" HIGH MOUNTING CURB		RECOMMENDED GRAVITY DAMPER		115 VOLT SPEED CONTROL	
	OD	STOCK NO.	OD	STOCK NO.	STOCK NO.	STOCK NO.
6	14 3/4	611214	11	411011	2727.1	N/A
8	14 3/4	611214	11	411011	2727.1	N/A
10	14 3/4	611214	11	411011	2727.1	N/A
12	22 1/4	611222	18	411018	2727.1	2828.1
15	22 1/4	611222	18	411018	N/A	2828.1

SPEED CONTROL 2727.1 MAX 1/3 HP-5 AMP 120V
2828.1 MAX 1/2 HP-10 AMP 120V

ALL DIMENSIONS IN INCHES, WEIGHTS IN POUNDS. OD IS OUTSIDE DIMENSION OF SQUARE CURB AND DAMPER. DUE TO CONTINUING RESEARCH, SOLER & PALAU RESERVES THE RIGHT TO CHANGE SPECIFICATIONS WITHOUT NOTICE.



ACCESSORIES

Solid State Speed Control:

Control is matched to the motor and blower wheel to allow continuous reduction in performance allowing adjustments of airflow for system balancing. CFM is reduced in direct proportion to motor speed reduction. Speed control is only available for 115 volt single phase. Exhauster performance can be controlled from the ventilated area.

AMCA SEAL



Soler & Palau, USA, certifies that the Models RED shown herein are licensed to bear the AMCA Seal. The ratings shown are based on test and procedures performed in accordance with AMCA Publication 211 and AMCA Publication 311 and comply with the requirement of the AMCA Certified Ratings Program.



LISTED POWER ROOF VENTILATOR
UL STANDARD 705

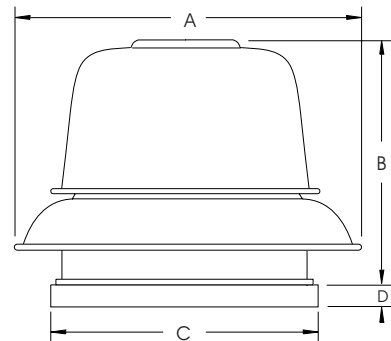

MODEL RED					Downblast Direct Drive Centrifugal Roof Exhauster									Ventilator with Open Drip-proof Motor	
Model RED	Motor Hp	Max. BHP	RPM	Sones @ 1/8 SP	CFM at Static Pressure									115/1/60	208-230/1/60
					0	1/8	1/4	3/8	1/2	5/8	3/4	7/8	1	Stock No.	Stock No.
6	1/10	0.05	1650	8.0	390	347	295	232	134	-	-	-	-	RED06JH1AS	RED06JH1CS
8	1/25	0.04	1050	4.5	573	468	326	-	-	-	-	-	-	RED08HM1AS	N/A
	1/10	0.12	1550	9.5	845	781	705	622	523	398	251	-	-	RED08JH1AS	RED08JH1CS
10	1/4	0.27	1600	12.4	1436	1348	1256	1155	1041	910	766	604	412	RED10MH1AS	RED10MH1CS
12	1/4	0.15	1150	8.9	1545	1356	1144	952	769	558	-	-	-	RED12MM1AS	RED12MM1CS
	1/2	0.52	1750	18.3	2352	2226	2104	1973	1832	1689	1562	1443	1324	RED12QH1AS	RED12QH1CS
15	1/2	0.46	1150	13.7	3003	2779	2540	2285	2038	1774	1480	1180	840	RED15QM1AS	RED15QM1CS

Speed (RPM) shown is normal. Performance is based on actual speed of test.
 Performance certified is for installation type A-free inlet, free outlet.
 Performance ratings include the effects of birdscreen in the airstream.

The sound ratings shown are the loudness values in the fan sones @ 5' (1.5m) in an hemispherical free field calculated per AMCA Standard 301.
 Values shown are for Installation Type A-Free inlet fan sone levels.

Performance Data at Reduced Speed														
Model RED	Motor HP	Max. BHP	RPM	Sones @ 1/8 SP	CFM at Static Pressure									
					0	1/8	1/4	3/8	1/2	5/8	3/4	7/8	1	
6-1550	1/10	0.02	950	2.4	224	133	-	-	-	-	-	-	-	-
		0.02	1100	3.5	260	187	-	-	-	-	-	-	-	-
		0.03	1250	4.6	295	234	146	-	-	-	-	-	-	-
		0.04	1450	6.2	343	293	229	131	-	-	-	-	-	-
8-1050	1/25	0.02	750	1.8	409	238	-	-	-	-	-	-	-	
8-1550	1/10	0.05	1150	5.5	627	535	417	249	-	-	-	-	-	
		0.10	1450	8.4	791	721	638	545	425	276	-	-	-	
10-1625	1/4	0.06	900	4.2	808	640	403	-	-	-	-	-	-	
		0.09	1100	6.3	987	856	696	489	-	-	-	-	-	
		0.15	1300	8.5	1167	1058	936	790	615	405	-	-	-	
		0.22	1500	11.0	1346	1253	1152	1042	910	762	594	393	-	
12-1075	1/4	0.08	900	5.8	1209	959	708	456	-	-	-	-	-	
		0.12	1050	7.6	1411	1202	970	771	553	-	-	-	-	
12-1625	1/2	0.17	1200	9.6	1613	1432	1231	1040	866	678	442	-	-	
		0.24	1350	11.8	1814	1653	1484	1299	1139	984	821	633	376	
		0.36	1550	14.9	2083	1942	1801	1645	1484	1344	1210	1073	929	
15-1140	1/2	0.14	750	6.3	1958	1599	1212	759	-	-	-	-	-	
		0.19	850	7.9	2219	1907	1567	1203	795	-	-	-	-	
		0.27	950	9.7	2481	2202	1902	1602	1256	887	-	-	-	
		0.36	1050	11.5	2742	2493	2228	1950	1672	1352	1019	621	-	

Model in reduced speed table indicates size and motor RPM of base unit.
 Performance is for that base unit operated at a reduced speed using the solid state speed control accessory.

AMCA Seal for sound rating does not apply to units with speed control.

Use 5 AMP Speed Control for motors 1/3 HP and smaller.
 Use 10 AMP Speed Control for motors 1/2.



MODEL TXD-UL762 (Sizes 10-15 only)

UPBLAST DIRECT DRIVE CENTRIFUGAL ROOF/SIDEWALL EXHAUSTER FOR RESTAURANT AND GENERAL APPLICATIONS



APPLICATION

Isolation of the motor from the air stream and the high velocity vertical (roof) or horizontal (wall) air discharge make the Model TXD ideally suited for the removal of dirty, contaminated and/or high temperature air from processes and buildings. Typical applications include restaurant hoods and similar kitchen exhaust ventilation, fume and smoke removal, laboratory fume hood exhaust and chemical process exhaust.

The non overloading wheel with its higher static pressure capability makes this unit suitable for either ducted or nonducted applications. Its roof or wall mounting permits location near the area to be ventilated, allowing short duct runs and more efficient operation. Direct drive units use smaller diameter wheels, resulting in low sound levels and quiet operation. They have no belts or fan bearings to maintain or adjust and consequently require very little maintenance.

CONSTRUCTION

Housing

- Heavy gauge aluminum housing and curb cap for strength and rigidity.
- Stainless steel exterior fasteners.
- Enclosed, ventilated motor compartment isolates motor from exhaust air.
- Neoprene isolators for reduction of vibration and sound.
- The motor compartment housing easily removes for complete maintenance access.
- Water-tight conduit tube for easy electrical connection without having to wire through the breather tube.
- Mounted disconnect is included on standard models.

Centrifugal Wheel

- Non overloading backward inclined for safe operation in ducted systems.
- Wheels constructed of non-corrosive aluminum.
- Statically and dynamically balanced for smooth operation.

DIMENSIONAL DATA

MODEL TXD	A	B	C	D	ROOF OPENING	Average Ship Wt. Lbs.
6	24	22	16 1/2	2	12	70
8	24	22	16 1/2	2	12	70
10	27 1/4	22	16 1/2	2	12	73
12	31 1/2	23	24	2	19 1/4	115
14	31 1/2	23	24	2	19 1/4	120
15	31 1/2	23	24	2	19 1/4	120

***You can not use a damper in a grease application**

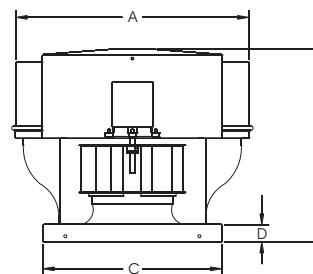

***Sizes 6-8 are not suitable for Restaurant applications**

MODEL TXD	RECOMMENDED 12" HIGH MOUNTING CURB		RECOMMENDED GRAVITY DAMPER		115 VOLT SPEED CONTROL	
	OD	STOCK NO.	OD	STOCK NO.	STOCK NO.	STOCK NO.
6	15	611214	11	411011	2727.1	N/A
8	15	611214	11	411011	2727.1	N/A

MODEL TXD	RECOMMENDED 12" HIGH MOUNTING CURB		RECOMMENDED GRAVITY DAMPER		115 VOLT SPEED CONTROL	
	OD	STOCK NO.	OD	STOCK NO.	STOCK NO.	STOCK NO.
10	15	611214	11	411011	2727.1	N/A
12	22 1/4	611222	18	411018	2727.1	2828.1
14	22 1/4	611222	18	411018	2727.1	N/A
15	22 1/4	611222	18	411018	N/A	2828.1

SPEED CONTROL 2727.1 MAX 1/3 HP-5 AMP 120V
2828.1 MAX 1/2 HP-10 AMP 120V

ALL DIMENSIONS IN INCHES, WEIGHTS IN POUNDS. OD IS OUTSIDE DIMENSION OF SQUARE CURB AND DAMPER. DUE TO CONTINUING RESEARCH, SOLER & PALAU RESERVES THE RIGHT TO CHANGE SPECIFICATIONS WITHOUT NOTICE.

Speed Controllable Motors

- Standard motors are single speed, speed controllable and drip-proof.
- All motors are rated for continuous duty.
- Disconnect is standard with single speed drip-proof motors.
- Motors ship mounted as standard.

ACCESSORIES

Solid State Speed Control:

Control is matched to the motor and blower wheel to allow continuous reduction in performance allowing adjustments of airflow for system balancing. CFM is reduced in direct proportion to motor speed reduction. Speed control is only available for 115 volt single phase. Exhauster performance can be controlled from the ventilated area.

AMCA SEAL



Soler & Palau USA, certifies that the Models TXD shown herein are licensed to bear the AMCA Seal. The ratings shown are based on test and procedures performed in accordance with AMCA Publication 211 and AMCA Publication 311 and comply with the requirement of the AMCA Certified Ratings Program.



LISTED POWER ROOF VENTILATOR
 UL STANDARD 705 sizes 6-8
 UL STANDARD 762 sizes 10-15 **ONLY**

MODEL TXD

Upblast Direct Drive Centrifugal Roof/Sidewall Exhauster

Ventilator with Open
Drip-proof Motor

Model TXD	Motor Hp	Max. BHp	RPM	Sones @ 1/8 SP	CFM at Static Pressure									115/1/60		208-230/1/60	
					0	1/8	1/4	3/8	1/2	5/8	3/4	7/8	1	Stock No.	Stock No.		
6	1/10	0.09	1795	7.7	410	370	328	276	203	-	-	-	-	TXD06JHIAS	TXD06JHICS		
8	1/4	0.07	1130	6.2	886	783	644	441	-	-	-	-	-	TXD08MMIAS	TXD08MMICS		
	1/4	0.24	1740	13.8	1364	1300	1232	1158	1072	960	851	698	510	TXD08MHIAS	TXD08MHICS		
10	1/4	0.27	1650	14.7	1527	1460	1398	1325	1236	1129	1011	883	747	TXD10MHIAS	TXD10MHICS		
12	1/4	0.16	1140	9.6	1616	1487	1338	1161	983	760	462	-	-	TXD12MMIAS	TXD12MMICS		
	1/2	0.55	1730	21.0	2453	2364	2281	2196	2097	1985	1867	1751	1638	TXD12QHIAS	TXD12QHICS		
14	1/4	0.25	1130	10.4	2060	1939	1798	1638	1439	1177	856	-	-	TXD14MMIAS	TXD14MMICS		
15	1/2	0.41	1155	13.2	2786	2653	2491	2313	2104	1863	1623	1362	969	TXD15QMIAS	TXD15QMICS		

Speed (RPM) shown is normal. Performance is based on actual speed of test.
Performance certified is for installation type A-free inlet, free outlet.
Performance ratings include the effects of birdscreen in the airstream.

The sound ratings shown are the loudness values in the fan sones @ 5' (1.5m) in an hemispherical free field calculated per AMCA Standard 301.
Values shown are for Installation Type A-Free inlet fan sone levels.

Performance Data at Reduced Speed														
Model TXD	Motor Hp	Max. BHp	RPM	Sones @ 1/8 SP	CFM at Static Pressure									
					0	1/8	1/4	3/8	1/2	5/8	3/4	7/8	1	
6-1550	1/10	0.02	1150	2.4	253	185	-	-	-	-	-	-	-	-
		0.05	1470	5.1	335	286	227	115	-	-	-	-	-	-
8-1075	1/4	0.01	680	1.2	533	302	-	-	-	-	-	-	-	-
		0.03	860	3.2	674	525	-	-	-	-	-	-	-	-
		0.05	1040	5.2	815	701	536	-	-	-	-	-	-	-
8-1625	1/4	0.10	1405	9.3	1101	1021	930	814	673	468	-	-	-	
10-1625	1/4	0.10	1185	7.8	1097	1007	896	742	561	318	-	-	-	
		0.20	1500	12.3	1388	1316	1245	1155	1043	914	771	615	407	
12-1075	1/4	0.03	680	3.3	964	712	352	-	-	-	-	-	-	
		0.08	905	6.5	1283	1116	897	649	-	-	-	-	-	
12-1625	1/2	0.17	1175	10.2	1666	1540	1399	1228	1060	855	599	-	-	
		0.32	1445	14.9	2049	1945	1844	1724	1586	1446	1310	1152	969	
14-1075	1/4	0.05	680	3.6	1240	1011	609	-	-	-	-	-	-	
		0.13	905	6.8	1650	1491	1294	1020	617	-	-	-	-	
15-1140	1/2	0.05	570	3.1	1375	1027	422	-	-	-	-	-	-	
		0.18	885	8.2	2135	1948	1710	1406	1087	-	-	-	-	

Model in reduced speed table indicates size and motor RPM of base unit.
Performance is for that base unit operated at a reduced speed using the solid state speed control accessory.

AMCA Seal for sound rating does not apply to units with speed control.

Use 5 AMP Speed Control for motors 1/3 HP and smaller.
Use 10 AMP Speed Control for motors 1/2.

CENTRIFUGAL ROOF & WALL EXHAUSTERS



MODEL TXB-UL762

UPBLAST BELT DRIVE

CENTRIFUGAL ROOF EXHAUSTER

FOR RESTAURANT AND GENERAL EXHAUST



APPLICATION

Isolation of motor and drive components from the air stream and the high velocity vertical air discharge make the model TXB-UL762 ideally suited for the removal of dirty, contaminated and/or high temperature air from processes and buildings. Typical applications include restaurant hoods and similar kitchen exhaust ventilation, fume and smoke removal, laboratory fume hood exhaust and chemical process exhaust.

For grease removal applications the fan must be installed per NFPA 96 and with a 40" discharge height and hinged access base.

CONSTRUCTION

Housing

- Heavy gauge aluminum housing and prepunched galvanized steel curb cap.
- Enclosed, ventilated motor/drive compartment isolates motor and drives from exhaust air.
- The motor compartment housing easily removes for complete maintenance access.
- Water-tight conduit tube for easy electrical connection without having to wire through the breather tube.
- External weather proof disconnect is included on standard models.

Centrifugal Wheel

- Non-overloading backward inclined for safe operation in ducted systems.
- Heavy aluminum hub for extra strength.
- Statically and dynamically balanced for smooth, quiet operation. Motors

Motors

- Single speed drip-proof motors are provided on standard models.
- All motors are rated for continuous duty.
- Disconnect switch is standard with single speed drip-proof motor.

Drives

- Sized for minimum 150% of drive horse power.
- Machined cast iron adjustable motor pulleys.
- Adjustable base for belt tensioning.
- Static resistant v-belt.

Bearings

- Heavy duty cast pillow block ball bearing type.
- Pre-lubricated with zerk fitting.
- Designed for 200,000 hour average life.

AMCA SEAL



Soler & Palau USA, certifies that the Models TXB shown herein are licensed to bear the AMCA Seal. The ratings shown are based on test and procedures performed in accordance with AMCA Publication 211 and AMCA Publication 311 and comply with the requirement of the AMCA Certified Ratings Program.

DIMENSIONAL DATA

MODEL TXB	A	B	C	D	E	ROOF OPENING	Average Ship Wt. Lbs.
8	16 1/2	24	24	27	1 3/4	11 3/4	69
10	16 1/2	27	26	29	1 3/4	11 3/4	69
12/15	24	31 1/2	26	28 3/4	2 1/2	19 1/4	93
16	24	31 1/2	26	28 3/4	2 1/2	19 1/4	93
18/20	29 1/2	37 3/4	28 1/2	31 3/4	2 1/2	24 3/4	120
24	35 1/2	47 1/4	31 1/2	41	2 1/2	30 3/4	245
30	42 1/2	56 3/4	42 1/2	44	2 1/2	37 3/4	365
36	42 1/2	66	47 1/2	46	2 1/2	37 3/4	365
42	55	72 1/2	49 1/4	51 1/2	2 1/2	50 1/4	385
48	55	78 3/4	53	55	2 1/2	50 1/4	490



LISTED POWER ROOF VENTILATOR
UL STANDARD 705
UL STANDARD 762

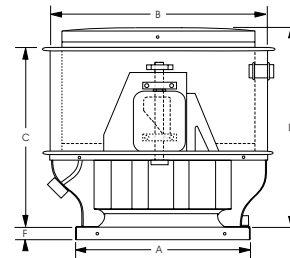

MODEL TXD	RECOMMENDED 12" HIGH MOUNTING CURB (1)		18" HIGH MOUNTING CURB	RECOMMENDED DAMPER		FAN LESS MOTOR & DRIVE
	OD	STOCK NO.	STOCK NO.	OD	STOCK NO.	STOCK NO.
8	15	611214	611815 V	11	411011	TXB08RHULLMDS
10	15	611214	611815 V	11	411011	TXB10RHULLMDS
12/15	22 1/2	611222	611823 V	18	411018	TXB12RHULLMDS/TXB15RHULLMDS
16	22 1/2	611222	611823 V	18	411018	TXB16RHULLMDS
18/20	27 3/4	611227	611828 V	24	411024	TXB18RHULLMDS/TXB20RHULLMDS
24	33 3/4	611233	611834 V	30	411030	TXB24RHULLMDS
30	40 3/4	611240	611841 V	36	611036	TXB30RHULLMDS (3)
36	40 3/4	611240	611841 V	36	611036	TXB36RHULLMDS (3)
42	53 1/4	611253	611854 V	48	611048	TXB42RHULLMDS (3)
48	53 1/4	611253	611854 V	48	611048	TXB48RHULLMDS (3)

1 - RESTAURANT CURBS MUST BE 18" HIGH MINIMUM PER NFPA-96.

2 - DO NOT USE DAMPER FOR FANS IN GREASE REMOVAL APPLICATIONS PER NFPA 96.

3 - MAXIMUM 3 HP MOTOR - CONTACT FACTORY FOR 5 HP CONSTRUCTION.

ALL DIMENSIONS IN INCHES, WEIGHTS IN POUNDS. OD IS OUTSIDE DIMENSION OF SQUARE CURB AND DAMPER.

DUE TO CONTINUING RESEARCH, SOLER & PALAU RESERVES THE RIGHT TO CHANGE SPECIFICATIONS WITHOUT NOTICE.

MODEL TXB-UL762					Upblast Belt Drive Centrifugal Restaurant Roof Exhauster								Ventilator with Open Drip-proof Motor and Drive Assembly	
Model TXB	Motor Hp	Max. BHP	RPM	Sones @ 1/4 SP	CFM at Static Pressure								115/1/60*	208-230/460/3/60
					0	1/4	3/8	1/2	5/8	3/4	1	1 1/4	Stock No.	Stock No.
8	1/4	0.10	1520	9.8	818	681	628	526	384	-	-	-	TXB08RHULMLIS	N/A
	1/4	0.22	1995	15.9	1074	955	912	875	834	766	583	-	TXB08RHULMHIS	N/A
	1/3	0.33	2270	19.9	1222	1111	1070	1034	1001	969	858	697	TXB08RHULPHIS	N/A
10	1/4	0.24	1365	6.8	1339	1146	1033	903	750	558	-	-	TXB10RHULMHIS	TXB10RHULMH3S
	1/3	0.34	1530	11.8	1501	1334	1238	1133	1015	881	530	-	TXB10RHULPHIS	TXB10RHULPH3S
	1/2	0.52	1765	19.0	1731	1589	1511	1428	1338	1240	1015	727	TXB10RHULQHIS	TXB10RHULQH3S
12	1/4	0.24	1365	4.8	1507	1353	1281	1201	1107	996	703	-	TXB12RHULMHIS	TXB12RHULMH3S
	1/3	0.35	1645	5.8	1652	1509	1446	1378	1302	1215	-	-	TXB12RHULPHIS	TXB12RHULPH3S
	1/2	0.54	1890	7.7	1898	1769	1715	1659	1600	1537	1390	1211	TXB12RHULQHIS	TXB12RHULQH3S
15	1/4	0.25	995	9.5	2208	1899	1747	1553	1286	-	-	-	TXB15RHULMHIS	TXB15RHULMH3S
	1/3	0.33	1095	11.3	2430	2146	2015	1864	1677	1431	-	-	TXB15RHULPHIS	TXB15RHULPH3S
	1/2	0.50	1255	14.5	2785	2541	2416	2302	2172	2021	1609	-	TXB15RHULQHIS	TXB15RHULQH3S
	3/4	0.75	1435	18.3	3184	2972	2862	2755	2656	2548	2288	1941	TXB15RHULRHIS	TXB15RHULRH3S
16	1	1.02	1590	22	3528	3334	3241	3139	3044	2955	2755	2511	TXB15RHULSHIS	TXB15RHULSH3S
	1/2	0.51	1000	15.5	3270	2986	2820	2628	2414	2161	1105	-	TXB16RHULQHIS	TXB16RHULQH3S
	3/4	0.71	1110	19.0	3629	3367	3249	3073	2906	2716	2243	-	TXB16RHULRHIS	TXB16RHULRH3S
18	1	0.98	1235	23	4038	3794	3693	3574	3410	3261	2902	-	TXB16RHULSHIS	TXB16RHULSH3S
	1/2	0.50	940	12.5	3382	3058	2886	2696	2488	2243	-	-	TXB18RHULQHIS	TXB18RHULQH3S
	3/4	0.74	1075	16.0	3868	3584	3442	3288	3123	2950	2786	2816	TXB18RHULRHIS	TXB18RHULRH3S
	1	1.04	1200	19.4	4318	4063	3937	3808	3668	3521	3201	3621	TXB18RHULSHIS	TXB18RHULSH3S
20	1 1/2	1.49	1350	24	4857	4630	4518	4406	4291	4169	3906	-	TXB18RHULTHIS	TXB18RHULTH3S
	1/2	0.54	775	12.5	4152	3666	3392	3054	2554	1910	-	-	TXB20RHULQHIS	TXB20RHULQH3S
	3/4	0.77	875	15.7	4688	4264	4034	3784	3482	3067	1902	2072	TXB20RHULRHIS	TXB20RHULRH3S
	1	1.07	975	19.1	5224	4848	4646	4436	4208	3944	3175	3808	TXB20RHULSHIS	TXB20RHULSH3S
24	1 1/2	1.60	1115	24	5974	5649	5477	5300	5116	4923	4470	-	TXB20RHULTHIS	TXB20RHULTH3S
	1/3	0.33	495	8.0	4555	3731	3018	-	-	-	-	-	TXB24RHULPHIS	TXB24RHULPH3S
	1/2	0.50	565	10.3	5199	4519	4063	3346	-	-	-	-	TXB24RHULQHIS	TXB24RHULQH3S
	3/4	0.75	650	13.6	5981	5413	5072	4661	4099	2979	-	-	TXB24RHULRHIS	TXB24RHULRH3S
	1	1.03	720	16.6	6626	6123	5835	5509	5124	4623	-	2245	TXB24RHULSHIS	TXB24RHULSH3S
	1 1/2	1.51	820	22	7546	7113	6874	6616	6332	6010	5146	5433	TXB24RHULTHIS	TXB24RHULTH3S
30	2	2.00	900	26	8282	7892	7681	7457	7216	6956	6339	-	TXB24RHULVHIS	TXB24RHULVH3S
	1/2	0.50	405	7.5	6240	5466	4315	-	-	-	-	-	TXB30RHULQHIS	TXB30RHULQH3S
	3/4	0.76	465	9.6	7356	6730	5973	4894	-	-	-	-	TXB30RHULRHIS	TXB30RHULRH3S
	1	1.00	510	11.5	8176	7622	7003	6221	5125	-	-	-	TXB30RHULSHIS	TXB30RHULSH3S
	1 1/2	1.51	585	14.8	9525	9055	8555	8001	7334	6495	-	-	TXB30RHULTHIS	TXB30RHULTH3S
	2	2.07	650	17.7	10680	10263	9827	9364	8855	8262	6658	7730	TXB30RHULVHIS	TXB30RHULVH3S
	3	3.00	735	22	12177	11812	11437	11047	10637	10199	9152	11522	N/A	TXB30RHULWH3S
36	5	5.05	875	28	14623	14319	14011	13696	13373	13040	12332	-	N/A	TXB30RHULXH3S
	3/4	0.75	355	7.7	10252	8369	6717	-	-	-	-	-	TXB36RHULRHIS	TXB36RHULRH3S
	1	1.03	395	9.4	11407	9844	8611	6793	-	-	-	-	TXB36RHULSHIS	TXB36RHULSH3S
	1 1/2	1.53	450	12.0	12996	11710	10832	9685	8075	6094	-	-	TXB36RHULTHIS	TXB36RHULTH3S
	2	2.04	495	14.2	14295	13165	12449	11560	10483	8988	-	-	TXB36RHULVHIS	TXB36RHULVH3S
	3	3.03	565	17.7	16317	15361	14795	14146	13377	12455	9936	13471	N/A	TXB36RHULWH3S
42	5	5.05	670	24	19349	18568	18131	17654	17131	16548	15128	-	N/A	TXBRHULXH3S
	1 1/2	1.49	330	13.1	17005	14449	12322	9513	-	-	-	-	TXB42RHULTHIS	TXB42RHULTH3S
	2	2.01	365	15.1	18809	16553	15207	12488	10337	6123	-	-	TXB42RHULVHIS	TXB42RHULVH3S
	3	2.86	410	17.7	21128	19154	18055	16774	14170	12073	-	12017	N/A	TSB42RHULWH3S
48	5	5.04	495	23	25508	23901	23052	22152	21173	19975	15519	-	N/A	TXB42RHULXH3S
	2	2.04	300	8.8	20670	17694	15399	11849	-	-	-	-	TXB48RHULVHIS	TXB48RHULVH3S
	3	2.98	340	11.0	23426	20771	19458	17054	14121	9830	-	-	N/A	TXB48RHULWH3S
48	5	5.05	405	15.5	27904	25598	24574	23485	21877	19631	13520	-	N/A	TXB48RHULXH3S

Power ratings (BHP) do not include transmission losses.
 Performance certified is for installation type A-free inlet, free outlet. Performance ratings include the effects of birdscreen in the airstream.
 The sound ratings shown are loudness values in fan sones @ 5' (1.5m) in a hemispherical free field calculated per AMCA Standard 301.
 Values shown are for installation Type A-Free inlet fan sone levels.
 *Tri-voltage (115-208-230) is standard on 3/4 through 1 1/2 Hp Single phase motors. Tri-voltage is available for the 1/2 Hp motors. Inquire for price and delivery.
 575/3/60 ODP Motors are available for most motor HP's - Refer to Price List.



MODEL CWD

DIRECT DRIVE CENTRIFUGAL SIDEWALL EXHAUSTER



APPLICATION

Models CWD are used to exhaust relatively clean air from a variety of industrial, commercial and institutional buildings such as machinery and equipment rooms, storage areas, office buildings, restaurants, retail stores, schools and similar buildings.

The non-overloading centrifugal wheel with its high static pressure capability, makes it suitable for either ducted or non-ducted applications.

The spun aluminum exterior provides a pleasing appearance, weather proof construction and resistance to corrosion. The low silhouette design is less noticeable on the building exterior and the removable dome provides easy access to the fan interior for service and cleaning.

Direct drive units use smaller diameter wheels, resulting in low sound levels and quiet operation. They have no belts or fan bearings to maintain or adjust and consequently require very little maintenance.

CONSTRUCTION

Housing

- Spun aluminum dome for weather protection and attractive appearance.
- Ventilated motor compartment with motor out of air stream for long trouble-free service.
- Dome easily removes for access to motor compartment.
- Weather-tight construction with aluminum birdscreen.
- Round duct connection provided at wheel inlet.

Centrifugal Wheel

- Non overloading backward inclined for safe operation in ducted systems.
- Statically and dynamically balanced for smooth, quiet operation.

Motors

- Speed controllable motors available on most models.
- Single speed open drip-proof are standard.
- Plug disconnect switch standard with single speed drip-proof motors.

DIMENSIONAL DATA

MODEL CWD	A	B	C	D	E	G	Average Ship Wt. Lbs.
7	15	8	5 5/16	1 1/2	8	8	15
8	20	9	9 15/16	2	12	11	25
9	26	13 1/2	11 15/16	3	15	14	37
10	26	13 1/2	11 15/16	3	15	14	37
12	30	15 1/2	13 15/16	3	17 1/2	14	50
14	36	16 1/2	17 15/16	4	22	18	84

MODEL CWD	RECOMMENDED GRAVITY DAMPER		115 VOLT SPEED CONTROL	230 VOLT SPEED CONTROL
	OD	STOCK NO.	STOCK NO.	STOCK NO.
7	8 x 8	411008	2727.1	N/A
8	11 x 11	411011	2727.1	N/A
9	14 x 14	411014	2727.1	3232.1
10	14 x 14	411014	2727.1	3232.1
12	14 x 14	411014	2727.1	3232.1
14	18 x 18	411018	2828.1	3232.1

SPEED CONTROL 2727.1 MAX 1/3 HP-5 AMP 120V
2828.1 MAX 1/2 HP-10 AMP 120V

ALL DIMENSIONS IN INCHES, WEIGHTS IN POUNDS.

DUE TO CONTINUING RESEARCH, SOLER & PALAU RESERVES THE RIGHT TO CHANGE SPECIFICATIONS WITHOUT NOTICE.

ACCESSORIES

Solid State Speed Control:

Control is matched to the motor and blower wheel to allow continuous reduction in performance allowing adjustments of airflow for system balancing. CFM is reduced in direct proportion to motor speed reduction. Speed control is only available for 115 volt single phase. Exhauster performance can be controlled from the ventilated area.

AMCA SEAL



Soler & Palau USA, certifies that the Models CWD shown herein are licensed to bear the AMCA Seal. The ratings shown are based on test and procedures performed in accordance with AMCA Publication 211 and AMCA Publication 311 and comply with the requirement of the AMCA Certified Ratings Program.



LISTED POWER ROOF VENTILATOR
 UL STANDARD 705

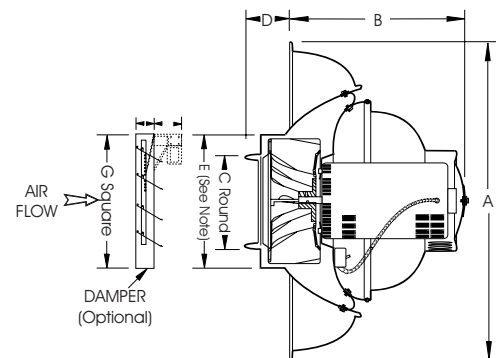

MODEL CWD

Direct Drive Centrifugal Sidewall Exhauster

Ventilator with Open
Drip-proof Motor

Model CWD	Motor Hp	Max. BHp	RPM	Sones @ 1/8 SP	CFM at Static Pressure										115/1/60		208-230/1/60	
					0	1/8	1/4	3/8	1/2	5/8	3/4	7/8	1	Stock No.	Stock No.			
7	1/25	0.04	1550	5.9	254	220	179	127	66	-	-	-	-	CWD07HH1AS	N/A			
8	1/15	0.07	1550	11.4	524	463	390	320	249	186	132	-	-	CWD08IH1AS	N/A			
9	1/4	0.12	1140	6.4	898	755	564	390	221	-	-	-	-	CWD09MM1AS	CWD09MM1CS			
	1/4	0.26	1550	11.4	1221	1126	1009	894	771	645	545	-	-	CWD09MH1AS	CWD09MH1CS			
10	1/3	0.33	1575	15.4	1453	1355	1252	1118	921	785	663	548	433	CWD10PH1AS	CWD10PH1CS			
12	1/4	0.26	1100	10.6	1583	1393	1195	995	813	618	410	193	-	CWD12MM1AS	CWD12MM1CS			
14	1/2	0.50	1080	15.7	2585	2454	2281	2040	1722	1433	1170	906	670	CWD14QM1AS	CWD14QM1CS			

Speed (RPM) shown is normal. Performance is based on actual speed of test.
Performance certified is for installation type A-free inlet, free outlet.
Performance ratings include the effects of birdscreen in the airstream.

The sound ratings shown are the loudness values in the fan sones @ 5' (1.5m) in an hemispherical free field calculated per AMCA Standard 301.
Values shown are for Installation Type A-Free inlet fan sone levels.

Performance Data at Reduced Speed

Model CWD	Motor Hp	Max. BHp	RPM	Sones @ 1/8 SP	CFM at Static Pressure									
					0	1/8	1/4	3/8	1/2	5/8	3/4	7/8	1	
7-1550	1/25	0.02	930	1.5	152	84	-	-	-	-	-	-	-	-
		0.02	1230	3.4	202	156	93	-	-	-	-	-	-	-
8-1550	1/15	0.02	930	3.5	320	209	98	-	-	-	-	-	-	-
		0.05	1225	6.4	421	339	251	167	-	-	-	-	-	-
9-1075	1/4	0.03	685	1.9	540	258	-	-	-	-	-	-	-	-
		0.08	940	4.3	741	554	330	-	-	-	-	-	-	-
9-1625	1/4	0.09	1030	5.6	811	651	467	313	-	-	-	-	-	
10-1625	1/3	0.10	1030	7.2	950	794	540	357	173	-	-	-	-	
12-1075	1/4	0.07	685	3.6	986	670	365	-	-	-	-	-	-	
		0.15	900	7.0	1296	1058	816	589	340	-	-	-	-	
14-1140	1/2	0.14	685	6.7	1640	1382	913	498	-	-	-	-	-	
		0.30	900	11.0	2154	1987	1730	1346	1028	711	390	-	-	

Model in reduced speed table indicates size and motor RPM of base unit.
Performance is for that base unit operated at a reduced speed using the solid state speed control accessory.

AMCA Seal for sound rating does not apply to units with speed control.

Use 5 AMP Speed Control for motors 1/3 HP and smaller.
Use 10 AMP Speed Control for motors 1/2.